

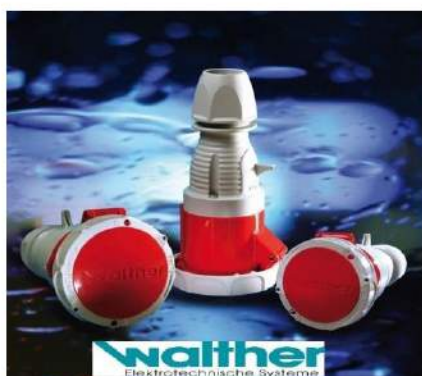

Penta Engineering Services Sdn Bhd

Price List 2015



w.e.f. 1 April 2015 (without GST)



THINK HENSEL

Sl.No.	Cable Size	Box Dimensions (LxBxH) (mm)	Catalog No. WITHOUT TERMINALS	Price RM Each	Catalog No. WITH TERMINALS	Price RM Each
--------	------------	-----------------------------	-------------------------------	---------------	----------------------------	---------------

Cable Junction Boxes IP 55 with membranes for cable entry

1.	1.5 - 2.5 sq.mm	76 x 76 x 53	DE 9220	12.40	DE 9225	27.60
1.	2.5 sq.mm	88 x 88 x 47	DE 9320	28.50	DE 9325	41.40
2.	4 sq.mm	98 x 98 x 52	DE 9340	34.80	DE 9345	47.10

Cable Junction Boxes IP 65 with "plain walls"

1.	2.5 sq.mm	88 x 88 x 53	D 8020	27.10		
2.	2.5 sq.mm	88 x 88 x 53	D 8120	27.10		
3.	4 sq.mm	98 x 98 X 58	D 8040	39.00		
4.	6 sq.mm	139 x119 x 70	K 8060	72.20		
5.	10 sq.mm	167 x 125 x 82	K 8100	83.60		
6.	16/25 sq.mm	200 x 160 x 98	K 8250	145.40		
7.	16/35 sq.mm	260 x 210 x 116	K 8350	228.40		
8.	25/35/50 sq.mm	210 x 310 x 116	K 8500	662.50		

Cable Junction Boxes IP 55 / IP 65 with metric knockouts for cable entry

1.	2.5 sq.mm	88 x 88 x 53	D 9020	33.90	D 9025	46.10
2.	2.5 sq.mm (With external fastening)	88 x 88 x 53	D 9120	33.90	D 9125	46.10
3.	2.5 sq.mm (With red lid)	88 x 88 x 53	D 9220	42.90	D 9225	55.10
4.	4 sq.mm	98 x 98 x 61	D 9040	45.60	D 9045	57.90
5.	4 sq.mm (With red lid)	98 x 98 x 61	D 9240	54.70	D 9245	63.40
6.	6 sq.mm	139 x 119 x 70	K 9060	81.70	K 9065	110.20
7.	10 sq.mm	167 x 125 x 82	K 9100	93.10	K 9105	141.70
8.	16/25 sq.mm	200 x160 x 98	K 9250	165.90	K 9255	256.40
9.	16/35 sq.mm	260 x 210 x 116	K 9350	250.00	K 9355	487.30
10.	25/35/50 sq.mm	210 x 310 x 116	K 9500	662.50	K 9502	773.30
11.	25/35/50 sq.mm	210 x 310 x 116	K 9500	662.50	K 9504 (4 terminals)	953.70
12.	25/35/50 sq.mm	210 x 310 x 116	K 9500	662.50	K 9505 (5 terminals)	1069.50
13.	50/70 sq.mm	300 x 450 x 170	Mi 0301	1064.80	K 7004 (4 terminals)	1763.30
14.	50/70 sq.mm	300 x 450 x 170	Mi 0301	1064.80	K 7005 (5 terminals)	1916.70
15.	150 sq.mm	300 x 450 x 170	Mi 0301	1064.80	K 1204 (4 terminals)	3253.80
16.	150 sq.mm	300 x 450 x 170	Mi 0301	1064.80	K 1205 (5 terminals)	3494.00
17.	240 sq.mm	300 x 600 x 170	Mi 0401	1269.60	K 2404 (4 terminals)	4219.30
18.	240 sq.mm	300 x 600 x 170	Mi 0401	1269.60	K 2405 (5 terminals)	4764.30

Cable Junction Boxes with "Terminal Blocks" IP 65 (with " Plain walls")

Sl.No	Cable Size	No. Of Terminals	Box Dimensions	Catalog No.	Price RM Each
1.	1.5 sq.mm	9	88 x 88 x 53	TB 0209 E	74.00
2.	2.5 sq.mm	16	139 x 119 x 70	TB 0216 E	148.10
3.	2.5 sq.mm	16	139 x 119 x 70	TB 0216 C	148.10
4.	2.5 sq.mm	20	167 x 125 x 82	TB 0220 E	170.70
5.	2.5 sq.mm	20	167 x 125 x 82	TB 0220 C	170.70
6.	2.5 sq.mm	25	200 x 160 x 98	TB 0225 E	266.60
7.	2.5 sq.mm	25	200 x 160 x 98	TB 0225 C	266.60
8.	4 sq.mm	9	88 x 88 x 53	TB 0409 E	76.00
9.	4 sq.mm	9	88 x 88 x 53	TB 0409 C	76.00
10.	4 sq.mm	16	139 x 119 x 70	TB 0416 E	156.70
11.	4 sq.mm	16	139 x 119 x 70	TB 0416 C	156.70
12.	4 sq.mm	20	167 x 125 x 82	TB 0420 E	182.40
13.	4 sq.mm	20	167 x 125 x 82	TB 0420 C	182.40
14.	4 sq.mm	25	200 x 160 x 98	TB 0425 E	269.80
15.	4 sq.mm	25	200 x 160 x 98	TB 0425 C	269.80



Sl.No.	Cable Size	Box Dimensions (LxBxH) (mm)	Catalog No. WITHOUT TERMINALS	Price RM Each	Catalog No. WITH TERMINALS	Price RM Each
--------	------------	-----------------------------	-------------------------------	---------------	----------------------------	---------------

Cable Junction Boxes IP 66 "halogen free and weather proof" for outdoor installation (with metric knockouts for cable entry)



1.	2.5 sq.mm	88 x 88 x 53	KF 9020	67.90	KF 9025	81.30
2.	4 sq.mm	98 x 98 x 61	KF 9040	94.90	KF 9045	108.80
3.	6 sq.mm	139 x 119 x 70	KF 9060	141.50	KF 9065	172.20
4.	10 sq.mm	167 x 125 x 82	KF 9100	183.10	KF 9105	236.50
5.	16/25 sq.mm	200 x 160 x 98	KF 9250	338.30	KF 9255	436.20
6.	16/35 sq.mm	260 x 210 x 116	KF 9350	409.60	KF 9355	669.70
7.	25/35/50 sq.mm	210 x 310 x 116	KF 9500	814.00	KF 9505	1260.10

Cable Junction Boxes IP 66 "halogen free and weather proof" for outdoor installation (with "Plain Walls")



1.	2.5 sq.mm	88 x 88 x 53	KF 8020	67.90		
2.	4 sq.mm	98 x 98 x 58	KF 8040	94.90		
3.	6 sq.mm	139 x 119 x 70	KF 8060	141.50		
4.	10 sq.mm	167 x 125 x 82	KF 8100	183.10		
5.	16/25 sq.mm	200 x 160 x 98	KF 8250	338.30		
6.	16/35 sq.mm	260 x 210 x 116	KF 8350	409.60		
7.	25/35/50 sq.mm	210 x 310 x 116	KF 8500	814.00		

Cable Junction Boxes IP 66 "halogen free and weather proof" for outdoor installation (with metric knockouts for cable entry - Black Colour)



1.	2.5 sq.mm	88 x 88 x 53	KF 5020	67.90	KF 5025	81.30
2.	4 sq.mm	98 x 98 x 61	KF 5040	91.90	KF 5045	108.80
3.	6 sq.mm	139 x 119 x 70	KF 5060	141.50	KF 5065	172.20
4.	10 sq.mm	167 x 125 x 82	KF 5100	183.10	KF 5105	236.50
5.	16/25 sq.mm	200 x 160 x 98	KF 5250	338.30	KF 5255	436.20
6.	16/35 sq.mm	260 x 210 x 116	KF 5350	409.60	KF 5355	669.70
7.	25/35/50 sq.mm	310 x 210 x 116	KF 5500	814.00	KF 5505	1260.10

Cable Junction Boxes IP 66 "harsh environment and / or protected outdoor for outdoor installation (without knockouts)



1.	2.5 sq.mm	88 X 88 X 53	KF 4020	67.90		
2.	4 sq.mm	98 x 98 x 61	KF 4040	91.90		
3.	6 sq.mm	139 x 119 x 70	KF 4060	141.50		
4.	10 sq.mm	167 x 125 x 82	KF 4100	183.10		
5.	16/25 sq.mm	200 x 160 x 98	KF 4250	338.30		
6.	16/35 sq.mm	260 X 210 X 117	KF 4350	409.60		
7.	25/35/50 sq.mm	310 x 210 x 117	KF 4500	814.00		

Cable Junction Boxes IP 66/ IP 67 "saltwater - proof" for Marine offshore applications (with metric knock outs for cable entry - Black Colour)



1.	2.5 sq.mm	88 X 88 X 53	KD 5020	80.60	KD 5025	94.50
2.	4 sq.mm	98 X 98 X 61	KD 5040	112.80	KD 5045	126.70
3.	6 sq.mm	139 X 119 X 70	KD 5060	168.30	KD 5065	198.80
4.	10 sq.mm	167 X 125 X 82	KD 5100	217.80	KD 5105	271.00
5.	16/25 sq.mm	200 X 160 X 98	KD 5250	405.70	KD 5255	503.50
6.	16/35 sq.mm	260 X 210 X 117	KD 5350	511.40	KD 5355	771.60

Cable Junction Boxes IP 65 with screwless terminals

1.	4 sq.mm	139 X 119 X 70			KC 9045	108.80
2.	10 sq.mm	200 X 160 X 98			KC 9255	471.00
3.	16 sq.mm	260 X 210 X 117			KC 9355	556.10



THINK ACID PROOF



THINK HENSEL

ENYCASE

DK THERMOPLASTIC CABLE JUNCTION BOXES



Sl.No.	Cable Size	Box Dimensions (LxBxH) (mm)	Catalog No. WITH TERMINALS	Price RM Each
--------	------------	-----------------------------	----------------------------	---------------

Cable Junction Boxes IP 65 " (mounted grommets for cable entry - Orange Colour - sheet steel)

1.	4 sq.mm	150 X 150 X 80	FK 9025	925.50
2.	10 sq.mm	200 X 150 X 80	FK 9105	1058.30
3.	16 sq.mm	200 X 200 X 80	FK 9255	1381.80

Cable Junction Boxes IP 65 " (included grommets for cable entry - Orange Colour - Duroplastic)

1.	1.5 sq.mm	122 X 122 X 59	FK 7045	694.40
2.	4 sq.mm	168 X 143 X 71	FK 7105	865.60
3.	6 sq.mm	242 X 168 X 85	FK 7165	1100.90

Accessories for Cable Junction Boxes

Sl.No.	Description	Catalog No.	Price RM Each
1.	Terminal Set		
	a. Terminal Set 2.5 sq.mm / 4 sq.mm 5 pole	DKL 04	15.30
	b. Terminal Set 6 sq.mm 5 pole	KKL 06	33.90
	c. Terminal Set 10 sq.mm 5 pole	KLS 10	114.60
	d. Terminal Set 25 sq.mm 5 pole	KLS 25	194.90
	e. Terminal Set 16 - 50 sq.mm 4 pole	KLS 50	396.20
	f. Terminal Set 16 - 50 sq.mm 5 pole	KLS 51	492.00
2.	External Mounting Brackets (2 Nos)	DK AL 2	117.40
3.	Lead Sealing		
	a. For Cable Junction Boxes upto 6 sq.mm	PLS 06	22.30
	b. For Cable Junction Boxes from 10 sq.mm to 50 sq.mm	PLS 50	22.30
4.	Labeling system for circuit description - 5 pieces	DK BS 5	33.90

Empty Boxes IP 65

Sl.No.	Description	Box Dimensions (LxBxH) (mm)	TRANSPARENT LID		OPAQUE LID	
			Catalog No.	Price RM Each	Catalog No.	Price RM Each
1.	Size 1 box	300 x 150 x 170	K 0100	205.30	K 0101	205.30
2.	Size 2 box	300 x 300 x 170	K 0200	287.90	K 0201	287.90
3.	Size 3 box	300 x 450 x 170	K 0300	385.10	K 0301	385.10
4.	Size 4 box	300 x 600 x 170	K 0400	462.00	K 0401	462.00

ENYSUN PV Rated 1000V DC Enclosures IP 65 / IP 66

Sl.No.	Description	Box Dimensions (LxBxH) (mm)	Catalog No.	Price RM Each
--------	-------------	-----------------------------	-------------	---------------

KV PV Thermoplastic Empty Boxes IP 66

1.	Empty box	88 x 88 x 53	KF PV 0100	60.50
2.	Empty box	98 x 98 x 58	KF PV 0200	85.00
3.	Empty box	139 x 119 x 70	KF PV 0300	126.10
4.	Empty box	167 x 125 x 82	KF PV 0400	163.90
5.	Empty box	200 x 160 x 98	KF PV 0500	302.80
6.	Empty box	260 x 210 x 117	KF PV 0600	365.50
7.	Empty box	310 x 210 x 117	KF PV 0700	727.40

KV PC Small - type Distribution Boards IP 65

1.	4.5 modules	126 x 228 x 111	KV PC 8104	214.50
2.	9 modules	200 x 238 x 111	KV PC 8109	269.30

Accessories for KV PC

Sl.No.	Description	Catalog No.	Price RM Each
1.	Mounting Plate for 4.5 modules	KV BP 04	147.40
2.	Mounting Plate for 9 modules	KV BP 09	165.70





Catalog No.	Cable Entry	Sealing Range (mm dia)	Packing Quantity (Nos.)	Price RM Each
-------------	-------------	------------------------	-------------------------	---------------

Stepped Glands IP 54

STM 16	M 16	3.5 - 12	50	4.00
STM 20	M 20	5 - 16	20	4.00
STM 25	M 25	5 - 21	20	4.00
STM 32	M 32	13 - 26.5	10	4.00
STM 40	M 40	13 - 34	5	8.10

Grommets IP 55

ESM 16	M 16	4.5 - 11	50	4.00
ESM 20	M 20	6 - 13	20	4.00
ESM 25	M 25	9 - 17	20	4.00
ESM 32	M 32	9 - 23	10	4.00
ESM 40	M 40	17 - 30	5	7.80

Grommets IP 65

EDK 16	M 16	5 - 10	50	3.00
EDK 20	M 20	6 - 13	20	3.40
EDK 25	M 25	9 - 17	20	6.40
EDK 32	M 32	12 - 23	10	9.50
EDK 40	M 40	17 - 30	5	19.50

Grommets IP 65 for conduits

EDR 16	M 16	M 16	50	3.00
EDR 20	M 20	M 20	20	3.40
EDR 25	M 25	M 25	20	6.40
EDR 32	M 32	M 32	10	9.50
EDR 40	M 40	M 40	5	19.50

Combi Climate glands IP 66 /IP 67

KBM 20	M 20	M 20		99.50
KBM 25	M 25	M 25		139.10
KBM 32	M 32	M 32		193.90
KBS 20	M 20	M 20		99.50
KBS 25	M 25	M 25		139.10
KBS 32	M 32	M 32		193.90

ENYBOARD KV SMALL TYPE DISTRIBUTION BOARDS

SI.No.	Description	Box Dimensions (LxBxH) (mm)	Catalog No. WITH PE + N TERMINALS	Price RM Each
--------	-------------	-----------------------------	-----------------------------------	---------------

KV Thermoplastic Circuit Breaker Boxes IP 65 (with metric knockouts for cable entry)

1.	1 row 3 modules	102 x 197 x 92	KV 7103	204.90
2.	1 row 4 modules	126 x 228 x 111	KV 7104	254.60
3.	1 row 6 modules	146 x 238 x 111	KV 7106	266.40
4.	1 row 9 modules	202 x 238 x 111	KV 7109	326.70
5.	1 row 12 modules	295 x 333 x 129	KV 9112 M	515.30
6.	1 row 18 modules	400 x 333 x 129	KV 9118 M	767.10
7.	2 rows 24 modules	295 x 458 x 129	KV 9224 M	874.40
8.	2 rows 36 modules	403 x 483 x 129	KV 9236 M	1080.10
9.	3 rows 36 modules	295 x 583 x 129	KV 9336 M	1184.90
10.	4 rows 48 modules	295 x 708 x 129	KV 9448 M	1554.80
11.	3 rows 54 modules	403 x 630 x 129	KV 9354 M	4358.20

KV "Extra" Circuit Breaker Boxes IP 65 with additional space (Max. Installation depth 72 mm) for Electrical Devices / Terminal Blocks not to be manually actuated

1.	1 row 12 modules	295 x 458 x 129	KV 9220	691.20
2.	1 row 18 modules	403 x 483 x 129	KV 9230	896.20
3.	2 rows 24 modules	295 x 583 x 129	KV 9330	929.50
4.	3 rows 36 modules	295 x 708 x 129	KV 9440	1298.50
5.	2 rows 36 modules	403 x 630 x 129	KV 9350	1486.10

Note : Earth & Neutral Terminals not included

Accessories for KV Circuit Breaker Boxes

SI.No.	Description	Catalog No.	Price RM Each
1.	Threaded connecting glands for lateral box assembly IP 65	AVS 16	25.60
2.	Press in connecting glands for lateral box assembly	EVS 16	3.40





THINK HENSEL



Accessories for KV Circuit Breaker Boxes

Sl.No.	Description	Box Dimensions (LxBxH) (mm)	Catalog No.	Price RM Each
3.	Sealing lead to provide for sealing between rear and front of box			
	a. For boxes from 12 to 54 modules		KV PL 2	39.00
	b. For boxes from 3 to 9 modules		KV PL 3	39.00
4.	Locking facility by means of built in lock with profile cylinder incl. 2 keys			
	a. For boxes from 12 to 54 modules		KV ES 1	123.50
	b. For boxes from 3 to 9 modules		KV ES 3	123.50
5.	Reserve key for KV ES 1 or KV ES 3		KV ES 2	73.60
6.	a. Blanking strip (12 modules, 18 mm each)		AS 12	25.60
	b. Blanking strip (18 modules, 18 mm each)		AS 18	32.90
7.	Cable entry cover (spare)			
	a. For KV range 12 modules wide		KV EB 12	44.60
	b. For KV range 18 modules wide		KV EB 18	69.00
	c. For KV 7103		KV EB 03	13.90
	d. For KV 7104		KV EB 04	15.60
	e. For KV 7106		KV EB 06	19.00
	f. For KV 7109		KV EB 09	22.50
8.	N & PE terminals for subsequent installation in KV circuit breaker boxes			
	a. For KV 7103		KV FC 03	26.10
	b. For KV 7104		KV FC 04	32.90
	c. For KV 7106		KV FC 06	38.00
	d. For KV 7109		KV FC 09	41.90
	e. For KV 9112 M		KV FC 12	140.60

Empty Boxes IP 65 / IP 54

For installation of equipment with mounting plates or DIN Rails

1.	Box without mounting plate (with transparent lid)	136 x 253 x115	KG 9001	146.30
2.	Box without mounting plate (with transparent lid)	168 x 253 x115	KG 9002	160.60
3.	Box without mounting plate (with transparent lid)	217 x 253 x115	KG 9003	182.40
4.	Box without mounting plate (with opaque lid)	136 x 253 x 115	KG 9001 IN	146.30
5.	Box without mounting plate (with opaque lid)	168 x 253 x 115	KG 9002 IN	160.60
6.	Box without mounting plate (with opaque lid)	217 x 253 x 115	KG 9003 IN	182.40
7.	Box with mounting plate (with transparent lid)	295 x 583 x182	KV 9331	1164.10

Accessories for KV Empty Boxes

1.	Mounting plates, made of plastic 4mm thick with fastening screws			
	a. For KG 9001		KG MP 01	38.50
	b. For KG 9002		KG MP 02	52.40
	c. For KG 9003		KG MP 03	73.60
2.	DIN Rails with fastening screws			
	a. For KG 9001		KG TS 01	7.30
	b. For KG 9002		KG TS 02	8.80
	c. For KG 9003		KG TS 03	10.50
3.	PE & N terminals for Cu wires			
	a. For KG 9001		KG PN 01	58.00
	b. For KG 9002		KG PN 02	72.60
	c. For KG 9003		KG PN 03	99.90

ENYSTAR FP - QUICK BUILD ENCLOSURES IP 65

Sl.No	Description	Box Dimensions (LxBxH) (mm)	TRANSPARENT LID		OPAQUE LID	
			Catalog No.	Price RM Each	Catalog No.	Price RM Each
Eny Star Empty enclosures						
1.	Size 1 box	276 x 186 x 186	FP 0101	510.00	FP 0121	510.00
2.	Size 2 box	276 x 366 x 186	FP 0211	632.20	FP 0231	632.20
3.	Size 3 box	276 x 546 x 186	FP 0311	989.40	FP 0331	989.40
4.	Size 4 box	366 x 546 x 186	FP 0411	1179.20	FP 0431	1179.20

THINK QUALITY



THINK HENSEL

ENYSTAR

FP - QUICK BUILD ENCLOSURES IP65

HENSEL

TRANSPARENT LID

OPAQUE LID

SI.No.	Description	Box Dimensions (LxBxH) (mm)	Catalog No.	Price RM Each	Catalog No.	Price RM Each
Eny Star Circuit breaker boxes						
1.	1 row 12 modules	276 x 253 x 186	FP 1105	682.10		
2.	2 row 24 modules	276 x 433 x 186	FP 1215	964.30		
3.	3 row 36 modules	276 x 613 x 186	FP 1315	1461.40		
4.	3 row 51 modules	366 x 613 x 186	FP 1415	1795.50		

Eny Star Accessories

SI.No.	Description	Catalog No.	Price RM Each
1.	Busbar connector for 250A 5 pole	FP SV 25	398.00
2.	5 pole connection module	AM RK 150	820.80
3.	Spacers	FP DS 02	48.50
4.	Mounting plate 4 mm thick with fixing screws		
	a. For sizes 1,2,3	FP MP 10	99.90
	b. For sizes 2,3,4	FP MP 20	147.40
	c. For sizes 3,4	FP MP 30	229.00
	d. For size 4	FP MP 40	229.30
5.	Fastening screws, self tapping and galvanised length 13 mm	FP BZ 13	1.80
6.	Cover without cut-outs for retrofitting		
	a. For size 1	FP AP 10	88.40
	b. For size 2	FP AP 20	120.60
	c. For size 3	FP AP 30	178.60
	d. For size 4	FP AP 40	246.00
7.	Set with 2 sealing caps	FP PL 2	28.00
8.	Partition plates		
	a. 180 mm	FP TW 18	13.90
	b. 270 mm	FP TW 27	21.50
	c. 360 mm	FP TW 36	25.60
9.	Cable Entry Flanges		
	a. 270 mm (7 x M 16/25, 13 x M 20/25)	FP FM 225	125.50
	b. 270 mm (8 x M 25 / 32.2 x M 25/32/40)	FP FM 232	125.50
	c. 270 mm (2 X M 25/32, 5 X M 25/32/40)	FP FM 240	125.50
	d. 270 mm (2 x M20, 2 x M 25/32, 2 x M 32/40/50, 1 x M 40/50/63)	FP FM 263	125.50
	e. 270 mm without knockouts	FP FG 200	125.50
	f. 360 mm without knockouts	FP FG 300	167.10
	g. 270 mm with integrated grommets	FP FG 222	192.90
	h. 360 mm with integrated grommets	FP FG 331	256.50
	i. Cable insertion for 1 cable with 72 mm external dia	FP FG 272	205.10
	j. Cable insertion for 2 cables with 72 mm external dia	FP FG 273	285.90
10.	Cable strain relief	FP ZE 272	327.90
11.	Connector	FP GV 10	35.60
12.	Locking devices		
	a. Manual door lock	FP TS 1	82.10
	b. Tool operation lock	FP TW 1	28.50
13.	Dust protection cover - complete set of 10 pieces	FP TA 1	8.80
14.	External mounting brackets - set of 4 nos with screws	FP AL 40	95.00
15.	Mounting profile of length 1980 mm with 8 screws	FP MS 1	274.50



ENYMOD Mi DISTRIBUTORS IP 65 / IP 66

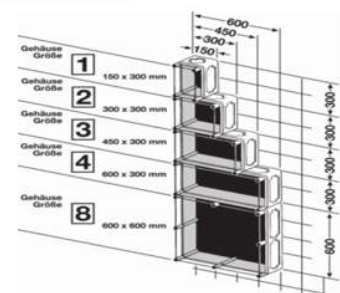



THINK HENSEL

TRANSPARENT LID

OPAQUE LID

Sl.No.	Description	Box Dimensions (LxBxH) (mm)	Catalog No.	Price RM Each	Catalog No.	Price RM Each
--------	-------------	-----------------------------	-------------	---------------	-------------	---------------

Mi - Boxes with Triangular locks

1.	Size 1 box	300 x 150 x 170	Mi 0100 T	549.80	Mi 0101 T	549.80
2.	Size 2 box	300 x 300 x 170	Mi 0200 T	678.30	Mi 0201 T	678.30
3.	Size 3 box	300 x 450 x 170	Mi 0300 T	1064.80	Mi 0301 T	1064.80
4.	Size 4 box	300 x 600 x 170	Mi 0400 T	1269.60	Mi 0401 T	1269.60
5.	Size 8 box	600 x 600 x 170	Mi 0800 T	2209.40	Mi 0801 T	2209.40
6.	Size 2 box with high lid	300 x 300 x 214	Mi 0210 T	731.60	Mi 0211 T	731.60
7.	Size 3 box with high lid	300 x 450 x 214	Mi 0310 T	1184.20	Mi 0311 T	1184.20
8.	Size 4 box with high lid	300 x 600 x 214	Mi 0410 T	1505.60	Mi 0411 T	1505.60

Mi boxes hinged doors with Triangular locks

1.	Size 2 box	300 x 300 x 182	Mi 0220 T	982.30	Mi 0221 T	982.30
----	------------	-----------------	-----------	--------	-----------	--------

Mi boxes hinged lids with Triangular locks

1.	Size 1 box	300 x 165 x 170	Mi 9100 T	624.80	Mi 9101 T	624.80
2.	Size 2 box	300 x 315 x 170	Mi 9200 T	753.20	Mi 9201 T	753.20
3.	Size 2 box with high lid	300 x 315 x 214	Mi 9210 T	805.90	Mi 9211 T	805.90
4.	Size 3 box	315 x 450 x 170	Mi 9300 T	1139.10	Mi 9301 T	1139.10
5.	Size 3 box with high lid	315 x 450 x 214	Mi 9310 T	1258.50	Mi 9311 T	1258.50
6.	Size 4 box	315 x 600 x 170	Mi 9400 T	1343.80	Mi 9401 T	1343.80
7.	Size 4 box with high lid	315 x 600 x 214	Mi 9410 T	1595.05	Mi 9411 T	1595.05

Mi - Empty Boxes

1.	Size 1 box	300 x 150 x 170	Mi 0100	549.80	Mi 0101	549.80
2.	Size 2 box	300 x 300 x 170	Mi 0200	678.30	Mi 0201	678.30
3.	Size 3 box	300 x 450 x 170	Mi 0300	1064.80	Mi 0301	1064.80
4.	Size 4 box	300 x 600 x 170	Mi 0400	1269.60	Mi 0401	1269.60
5.	Size 8 box	600 x 600 x 170	Mi 0800	2209.40	Mi 0801	2209.40
7.	Size 2 box with high lid	300 x 300 x 214	Mi 0210	731.60	Mi 0211	731.60
8.	Size 3 box with high lid	300 x 450 x 214	Mi 0310	1184.20	Mi 0311	1184.20
9.	Size 4 box with high lid	300 x 600 x 214	Mi 0410	1505.60	Mi 0411	1505.60

Mi boxes with hinged doors

1.	Size 2 box	300 x 300 x 182	Mi 0220	982.30	Mi 0221	982.30
----	------------	-----------------	---------	--------	---------	--------

Mi boxes with hinged lids

1.	Size 1 box	300 x 165 x 170	Mi 9100	624.80	Mi 9101	624.80
2.	Size 2 box	300 x 315 x 170	Mi 9200	753.20	Mi 9201	753.20
3.	Size 2 box with high lid	300 x 315 x 214	Mi 9210	805.90	Mi 9211	805.90
4.	Size 3 box	315 x 450 x 170	Mi 9300	1139.10	Mi 9301	1139.10
5.	Size 3 box with high lid	315 x 450 x 214	Mi 9310	1258.50	Mi 9311	1258.50
6.	Size 4 box	315 x 600 x 170	Mi 9400	1343.80	Mi 9401	1343.80
7.	Size 4 box with high lid	315 x 600 x 214	Mi 9410	1595.10	Mi 9411	1595.10

Mi - Circuit Breaker Boxes

Sl.No.	Description	Box Dimensions (LxBxH) (mm)	Catalog No.	Price RM Each
1.	1 row 12 modules with hinged flap	300 x 150 x 185	Mi 1111	1016.30
2.	1 row 12 modules	300 x 150 x 170	Mi 1112	789.20
3.	2 rows 24 modules with hinged lid	300 x 300 x 182	Mi 1220	1377.80
4.	2 rows 24 modules with hinged flaps	300 x 300 x 185	Mi 1222	1524.30
5.	2 rows 24 modules	300 x 300 x 170	Mi 1224	1073.80
6.	3 rows 36 modules with hinged flaps	300 x 450 x 185	Mi 1333	2249.00
7.	3 rows 36 modules	300 x 450 x 170	Mi 1336	1570.10
8.	4 rows 36 modules	300 x 600 x 170	Mi 1440	1679.10
9.	4 rows 36 modules with hinged flaps	300 x 600 x 185	Mi 1443	2376.00
10.	4 rows 48 modules with hinged flaps	300 x 600 x 185	Mi 1444	2818.80
11.	4 rows 48 modules	300 x 600 x 170	Mi 1448	1913.70

Prices of other Mi range boxes available on request





THINK HENSEL

SI.No.	Description	Box Dimensions (LxBxH) (mm)	Catalog No.	Price RM Each
--------	-------------	-----------------------------	-------------	---------------

Mi - Meter Boxes

1.	Size 2, depth 146 mm	300 x 300 x 170	Mi 2200	799.00
2.	Size 3, depth 146 mm	450 x 300 x 170	Mi 2300	1198.10
3.	Size 3, depth 190 mm	450 x 300 x 214	Mi 2310	1307.70
4.	Size 4, depth 146 mm	600 x 300 x 170	Mi 2400	1430.60
5.	Size 4, depth 190 mm	600 x 300 x 214	Mi 2410	1673.00
6.	Size 4, with window flap	600 x 300 x 228	Mi 2413	1888.70
7.	Size 4, with hinged flap with protection cover	600 x 300 x 192	Mi 2420	1682.60
8.	Size 8, with additional dinrail	600 x 600 x 170	Mi 2800	2626.50
9.	Size 8, with hinged flap with protection cover	600 x 600 x 192	Mi 2820	2877.80

Mi - Busbar Boxes

1.	Busbar rated current 250 A	300 x 300 x 170	Mi 6252	1174.90
2.	Busbar rated current 400 A	300 x 300 x 170	Mi 6255	1317.50
3.	Busbar rated current 630 A	300 x 300 x 170	Mi 6256	1682.10
4.	Busbar rated current 250 A	600 x 300 x 170	Mi 6452	2181.00
5.	Busbar rated current 400 A	600 x 300 x 170	Mi 6455	2456.80
6.	Busbar rated current 630 A	600 x 300 x 170	Mi 6456	3213.20

Accessories for Mi boxes

SI.No.	Description	Catalog No.	Price RM Each
1.	Connection Box with gaskets for mounting plug sockets, Push Buttons	Mi CB 10	277.40
2.	Extension frame suitable for increasing Installation depth by 85mm		
	a. Size 4	Mi ZR 4	634.50
	b. Size 8	Mi ZR 8	1064.80
3.	Mounting plate 4mm thick with fastening screws		
	a. For sizes 1,3,4	Mi MP 1	86.00
	b. For sizes 2 to 8	Mi MP 2	129.10
	c. For sizes 3,4	Mi MP 3	205.10
	d. For sizes 4,8	Mi MP 4	269.90
	e. For size 8	Mi MP 8	444.50
4.	DIN Rails with fastening screws		
	a. For sizes 1 to 8	Mi TS 30	38.50
	b. For size 3	Mi TS 45	49.50
	c. For sizes 4 & 8	Mi TS 60	60.40
5.	Spacers 2 pieces including screws		
	a. 25 mm High	Mi DS 25	36.10
	b. 50 mm High	Mi DS 50	55.10
6.	Fastening screws, self tapping and galvanised		
	a. Length 11 mm	Mi BZ 11	1.80
	b. Length 13 mm	Mi BZ 13	1.80
7.	Protection plate with fastening material suitable		
	a. For size 1	Mi EP 01 (blue) / Mi EP91 (grey)	179.50
	b. For size 2	Mi EP 02 (blue) / Mi EP92 (grey)	299.30
	c. For size 4	Mi EP 04 (blue) / Mi EP94 (grey)	517.80
8.	PE -or N - Terminals	Mi NK 14	105.50
9.	Cover Strips to cover blank modules		
	a. 12 modules, 18 mm each	AS 12	25.60
	b. 18 modules, 18 mm each	AS 18	32.90
10.	Wiring band, insulated, laminated copper, length 2 metres for		
	a. 100 A	Mi VS 100	211.90
	b. 160 A	Mi VS 160	370.50
	c. 250 A	Mi VS 250	551.90
	d. 400 A	Mi VS 400	782.80
	e. 630 A	Mi VS 630	1106.70



THINK HENSEL

Accessories for Mi boxes

Sl.No.	Description	Catalog No.	Price RM Each
11.	Wiring terminals suitable for		
	a. Mi VS 250 and Mi VS 400	VA 400	71.40
	b. Mi VS 630	VA 630	208.00
12.	Terminals for direct busbar connection		
	a. 1.5 - 16 sq.mm	KS 16 F	22.50
	b. 1.5 - 16 sq.mm	KS 16 Z	25.60
	c. 4 - 35 sq.mm	KS 35 F	30.50
	d. 4 - 35 sq.mm	KS 35 Z	45.60
	e. 10 - 70 sq.mm	KS 70 F	83.60
	f. 25 - 120 sq.mm	KS 120 F	83.10
	g. 25 - 120 sq.mm	KS 120 Z	108.40
	h. 35 - 240 sq.mm	KS 240 / 12	173.90
	i. 35 - 240 sq.mm	KS 240 / 20	TBA
	j. 35 - 150 sq.mm	KS 150	97.00
	k. 35 - 240 sq.mm	KS 240	TBA
	l. 150 - 240 sq.mm	KS 240 V	157.60
13.	Connecting terminals 25 sq.mm for installation on DIN Rails		
	a. 3 pole	KKL 34	135.00
	b. 4 pole	KKL 48	208.00
	c. 5 pole	KKL 54	194.90
14.	Wall gaskets	Mi WD 2	42.40
15.	Fixing spares	Mi BE	17.60
16.	Wall separator	Mi WT 1	86.00
17.	Busbar connectors with wall gasket for		
	a. 250 A 5 pole	Mi SV 25	441.80
	b. 400 A 5 pole / 630 A 5 pole	Mi SV 45	487.40
18.	Cable Entry Flanges with fastening wedges		
	a. 150mm (3 x M20, 1 x M 32 / 40 / 50)	Mi FM 15	96.00
	b. 150mm (Plain wall)	Mi FP 15	138.60
	c. 300mm (Plain wall)	Mi FP 20	138.60
	d. 300mm (15 x M16, 15 x M20)	Mi FM 20	138.60
	e. 300mm (19 x M 25)	Mi FM 25	138.60
	f. 300mm (8 x M25, 1 x M25 / 32 / 40)	Mi FM 32	138.60
	g. 300mm (2 x M25 / 32 ,M 32 / 40)	Mi FM 40	138.60
	h. 300mm (2 x M20, 4 x M32 / 40 / 50)	Mi FM 50	138.60
	i. 300mm (3 x M40 / 50 / 63)	Mi FM 60	138.60
	j. 300mm with extended cable arrangement space	Mi FM 63	200.50
	k. Cable insertion for max. 2 cables with 70 mm outer dia.	Mi FP 82	582.30
	l. Metal insert for flanges 300 mm without knockouts	Mi FP 30	
19.	Cable strain relief to be used only with Mi FP 82	Mi ZE 62	360.00
20.	Ventilation flange	Mi BF 20	226.00
21.	a. Hinged flap for subsequent installation in lids - 12 modules	Mi KL 12	309.60
	b. Hinged flap for subsequent installation in lids - 6 modules	Mi KL 6	232.90
22.	Locking device for hinged flap	Mi SK 01	138.60
23.	Locking device consisting of 2 cylindric locks, 2 keys		
	a. For Mi normal lid boxes	Mi ZS 01	255.50
	b. For Mi high lid boxes	Mi ZS 02	255.50
	c. Locking device to be used with Mi ZS 01 and Mi ZS 02	Mi ZS 03	56.00
24.	Locking device insertion to be used with Mi PL 2, Mi SR 4, Mi SN 4	Mi DV 01	10.50
25.	Set with 2 sealing caps	Mi PL 2	13.00
26.	Set with 4 fastening covers	Mi SR 4	41.40
27.	Set with 4 hand operation fasteners	Mi SN 4	43.60
28.	KWH meter window flap complete set of 4 parts	NZ KL 54	334.40
29.	Dust protection cover - complete set of 4 parts	Mi SA 2	2.70
30.	External mounting brackets - set of 4 nos with screws	Mi AL 40	95.00
31.	Mounting profile of length 1950 mm with 8 screws	Mi M	267.90

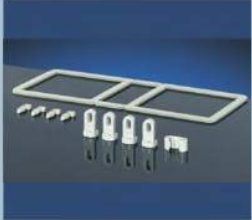



Description	Rating Amp.	No. of Poles	Degree of Protection	Catalog No.	Price RM Each
Wall Socket Outlet	16/20 A	2P + E	IP 44	110306	60.40
		3P + E	IP 44	110406	66.30
		3P + N + E	IP 44	110	66.30
	32 A	2P + E	IP 44	130306	77.30
		3P + E	IP 44	130406	81.60
		3P + N + E	IP 44	130	81.40
	63 A	2P + E	IP 44	161306	352.70
		3P + E	IP 44	161406	296.90
		3P + N + E	IP 44	161	296.90
Wall Socket Outlet Watertight	16/20 A	2P + E	IP 67	119306	131.50
		3P + E	IP 67	119406	143.70
		3P + N + E	IP 67	119	143.70
	32 A	2P + E	IP 67	139306	149.10
		3P + E	IP 67	139406	167.10
		3P + N + E	IP 67	139	167.10
	63 A	2P + E	IP 67	169306	382.40
		3P + E	IP 67	169406	349.00
		3P + N + E	IP 67	169	349.00
125 A	2P + E	IP 67	178306 OK	1970.00	
	3P + E	IP 67	178406 OK	2863.10	
	3P + N + E	IP 67	178 OK	2234.80	
Panel Mounting Socket Angled	16/20 A	2P + E	IP 44	510306	42.20
		3P + E	IP 44	510406	60.20
		3P + N + E	IP 44	510	60.20
	32 A	2P + E	IP 44	530306	64.10
		3P + E	IP 44	530406	74.80
		3P + N + E	IP 44	530	74.80
	63 A	2P + E	IP 44	560306	302.30
		3P + E	IP 44	560406	252.40
		3P + N + E	IP 44	560	252.40
Panel Mounting Socket Straight	16/20 A	2P + E	IP 44	410306	42.20
		3P + E	IP 44	410406	60.20
		3P + N + E	IP 44	410	60.20
	32 A	2P + E	IP 44	430306	64.10
		3P + E	IP 44	430406	74.80
		3P + N + E	IP 44	430	74.80
	63 A	2P + E	IP 44	460306	302.30
		3P + E	IP 44	460406	252.40
		3P + N + E	IP 44	460	252.40
Panel Socket Straight for container applications	32 A	3P + E	IP 67	439403	131.10
Plug for container applications	32 A	3P + E	IP 67	239403	175.10
Coupler for container applications	32 A	3P + E	IP 67	339403	199.00
Panel Mounting Socket Angled Watertight	16/20 A	2P + E	IP 67	519306	85.30
		3P + E	IP 67	519406	87.20
		3P + N + E	IP 67	519	87.20
	32 A	2P + E	IP 67	539306	120.10
		3P + E	IP 67	539406	116.50
		3P + N + E	IP 67	539	116.50
	63 A	2P + E	IP 67	569306	346.10
		3P + E	IP 67	569406	303.70
		3P + N + E	IP 67	569	303.70
125 A	2P + E	IP 67	579306	1095.50	
	3P + E	IP 67	579406	1007.30	
	3P + N + E	IP 67	579	1007.30	
Mondo Panel Socket	16/20A	2P + E	IP 44	415306	119.90
		3P + E	IP 44	415406	169.30
		3P + N + E	IP 44	415	175.10



THINK DUSTPROOF



THINK HENSEL

wather
CEEtyp

INSULATED PLUG SOCKETS



Description	Rating Amp.	No. of Poles	Degree of Protection	Catalog No.	Price RM Each
Panel Mounting Socket Straight Watertight	16/20 A	2P + E	IP 67	419306	85.30
		3P + E	IP 67	419406	89.20
		3P + N + E	IP 67	419	87.20
	32 A	2P + E	IP 67	439306	120.10
		3P + E	IP 67	439406	116.50
		3P + N + E	IP 67	439	116.50
	63 A	2P + E	IP 67	469306	346.10
		3P + E	IP 67	469406	303.70
		3P + N + E	IP 67	469	303.70
	125 A	2P + E	IP 67	479306	1095.50
		3P + E	IP 67	479406	1007.30
		3P + N + E	IP 67	479	1007.30
Plug	16/20 A	2P + E	IP 44	210306	28.80
		3P + E	IP 44	210406	41.20
		3P + N + E	IP 44	210	41.20
	32 A	2P + E	IP 44	230306	50.70
		3P + E	IP 44	230406	58.20
		3P + N + E	IP 44	230	58.20
	63 A	2P + E	IP 44	260306	271.80
		3P + E	IP 44	260406	239.40
		3P + N + E	IP 44	260	233.60
Plug Watertight	16/20 A	2P + E	IP 67	219306	68.20
		3P + E	IP 67	219406	92.30
		3P + N + E	IP 67	219	94.50
	32 A	2P + E	IP 67	239306	114.00
		3P + E	IP 67	239406	116.50
		3P + N + E	IP 67	239	116.50
	63 A	2P + E	IP 67	269306	343.70
		3P + E	IP 67	269406	276.00
		3P + N + E	IP 67	269	276.00
	125 A	2P + E	IP 67	279306	981.80
		3P + E	IP 67	279406	938.20
		3P + N + E	IP 67	279	938.20
Schuko Socket	16/20 A	2P + E	IP 44	10003	54.40
Schuko Plug	16/20 A	2P + E	IP 44	1418060	38.00
Coupler	16/20 A	2P + E	IP 44	310306	41.90
		3P + E	IP 44	310406	53.60
		3P + N + E	IP 44	310	53.60
	32 A	2P + E	IP 44	330306	61.20
		3P + E	IP 44	330406	75.50
		3P + N + E	IP 44	330	75.50
	63 A	2P + E	IP 44	360306	343.70
		3P + E	IP 44	360406	323.00
		3P + N + E	IP 44	360	323.00
Coupler with Gland entry Watertight	16/20 A	2P + E	IP 67	319306	100.40
		3P + E	IP 67	319406	114.30
		3P + N + E	IP 67	319	114.30
	32 A	2P + E	IP 67	339306	146.20
		3P + E	IP 67	339406	140.60
		3P + N + E	IP 67	339	141.80
	63 A	2P + E	IP 67	369306	343.70
		3P + E	IP 67	369406	323.00
		3P + N + E	IP 67	369	374.40
125 A	2P + E	IP 67	379306	1113.00	
	3P + E	IP 67	379406	1069.40	
	3P + N + E	IP 67	379	1069.40	





THINK HENSEL



Description	Rating Amp.	No. of Poles	Degree of Protection	Catalog No.	Price RM Each
-------------	-------------	--------------	----------------------	-------------	---------------



Appliance plug for Wall mounting	16/20 A	2P + E	IP 44	610306	136.90
		3P + E	IP 44	610406	144.70
		3P + N + E	IP 44	610	152.20
	32 A	2P + E	IP 44	630306	170.50
		3P + E	IP 44	630406	181.70
		3P + N + E	IP 44	630	193.20



Appliance plug for Panel mounting	16/20 A	2P + E	IP 44	611306	120.10
		3P + E	IP 44	611406	135.70
		3P + N + E	IP 44	611	155.40
	32 A	2P + E	IP 44	631306	175.10
		3P + E	IP 44	631406	181.00
		3P + N + E	IP 44	631	184.40
	63 A	2P + E	IP 44	661306	764.30
		3P + E	IP 44	661406	941.10
		3P + N + E	IP 44	661	983.50



Appliance Plug for Wall mounting	16/20 A	2P + E	IP 67	618306	224.10
		3P + E	IP 67	618406	236.50
		3P + N + E	IP 67	618	243.80
	32 A	2P + E	IP 67	638306	302.30
		3P + E	IP 67	638406	313.70
		3P + N + E	IP 67	638	325.40
	63 A	2P + E	IP 67	668306	1608.60
		3P + E	IP 67	668406	1639.10
		3P + N + E	IP 67	668	1701.40
	125 A	2P + E	IP 67	678306 OK	3936.70
		3P + E	IP 67	678406 OK	4166.60
		3P + N + E	IP 67	678 OK	4395.50



Appliance Plug for Panel mounting	16/20 A	2P + E	IP 67	619306	169.30
		3P + E	IP 67	619406	197.80
		3P + N + E	IP 67	619	224.60
	32 A	2P + E	IP 67	639306	231.90
		3P + E	IP 67	639406	243.10
		3P + N + E	IP 67	639	216.80
	63 A	2P + E	IP 67	669306	1085.80
		3P + E	IP 67	669406	1131.00
		3P + N + E	IP 67	669	1509.60
	125 A	2P + E	IP 67	679306	2867.00
		3P + E	IP 67	679406	3019.20
		3P + N + E	IP 67	679	3172.20

Interlocked Sockets / Wall Sockets with DIN Rail



Switched wall Socket, With interlocking, IP 44	16/20 A	2P + E	IP 44	AT 110 306	605.20
		3P + E	IP 44	AT 110 406	871.20
		3P + N + E	IP 44	AT 110	645.40
	32 A	2P + E	IP 44	AT 130 306	847.10
		3P + E	IP 44	AT 130 406	1286.40
		3P + N + E	IP 44	AT 130	927.70
	63 A	2P + E	IP 44	AE 160 306	1815.20
		3P + E	IP 44	AE 160 406	2410.10
		3P + N + E	IP 44	AE 160	1895.30



THINK HENSEL

Description	Rating Amp.	No. of Poles	Degree of Protection	Catalog No.	Price RM Each	
Switched wall Socket, With interlocking, IP 67	16/20 A	2P + E	IP 67	AT 119 306	605.20	
		3P + E	IP 67	AT 119 406	871.20	
		3P + N + E	IP 67	AT 119	645.40	
	32 A	2P + E	IP 67	AT 139 306	847.10	
		3P + E	IP 67	AT 139 406	1286.40	
		3P + N + E	IP 67	AT 139	1008.10	
	63 A	2P + E	IP 67	AE 169 306	1895.30	
		3P + E	IP 67	AE 169 406	2448.10	
		3P + N + E	IP 67	AE 169	1976.10	
	125 A	2P + E	IP 67	AO 179 306	5847.50	
		3P + E	IP 67	AO 179 406	9443.90	
		3P + N + E	IP 67	AO 179	6169.90	
Wall Socket With DIN - rail IP 44	16/20 A	2P + E	IP 44	AR 110 306 TS	788.90	
		3P + E	IP 44	AR 110 406 TS	963.50	
		3P + N + E	IP 44	AR 110 TS	963.50	
	32 A	2P + E	IP 44	AR 130 306 TS	1051.20	
		3P + E	IP 44	AR 130 406 TS	963.50	
		3P + N + E	IP 44	AR 130 TS	1095.50	
	63 A	2P + E	IP 44	AS 160 306 TS	1906.60	
		3P + E	IP 44	AS 160 406 TS	1927.90	
		3P + N + E	IP 44	AS 160 TS	1797.10	
	Wall socket, with DIN - rail, IP 67	16/20 A	2P + E	IP 67	AR 119 306 TS	1182.70
			3P + E	IP 67	AR 119 406 TS	1191.30
			3P + N + E	IP 67	AR 119 TS	1205.10
32 A		2P + E	IP 67	AR 139 306 TS	1227.00	
		3P + E	IP 67	AR 139 406 TS	1248.90	
		3P + N + E	IP 67	AR 139 TS	1248.90	
63 A		2P + E	IP 67	AS 169 306 TS	1732.80	
		3P + E	IP 67	AS 169 406 TS	1752.80	
		3P + N + E	IP 67	AS 169 TS	2234.80	
125A		3P + E	IP 67	AS 179 406 TS	3983.20	
		3P + N + E	IP 67	AS 179 TS	4024.60	



PUSH BUTTON STATIONS

Sl.No.	Description	Catalog No.	Price Each
1.	Selector Actuator Station IP 65	SA 0101	209.30
2.	Emergency Stop Push Button Station IP 65	PBS 0101	294.20
3.	Emergency Stop Push Button Station IP 65	PBS 0101 K	797.30
4.	2 way Push Button Station IP 65	PBS 0201	250.40
5.	3 way Push Button Station IP 65	PBS 0301	452.40
6.	3 way Push Button Station IP 65 with terminals	PBS 0301 TB	656.50
7.	2 way Push Button Station with L/R or A/M Selector Switch with OFF	PSS 0201	413.90
8.	2 way Push Button Station with Ammeter IP 65	PSA 0201	407.70
9.	2 way Push Button Station with L/R or A/M and Selector Switch with OFF and Ammeter	PSSA 0201	434.30

Note: Please mention about Ammeter ratio while placing the order.

RUBBER CABLE DRUMS



Sl.No.	Description	Catalog No.	Price Each
1.	Empty Cable Drum 235mm dia	GT235.SO	414.70
2.	Empty Cable Drum 310mm dia	GT310.SO	665.10
3.	Empty Cable Drum 380mm dia	GT380.SO	1421.50
4.	Empty Cable Drum 450mm dia	GT450.SO	1682.80

Customized solutions available as per Individual requirements



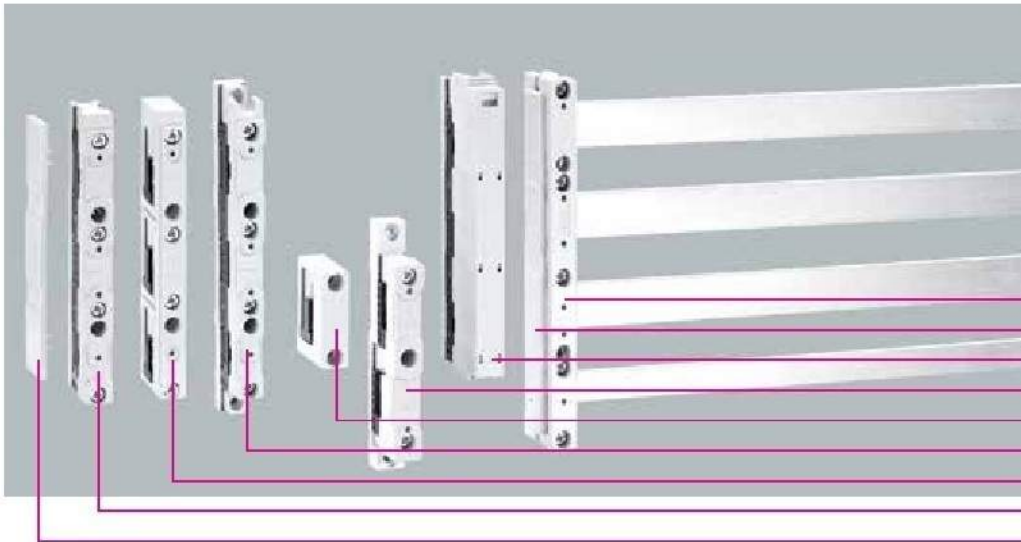

01 485
01 131
01 484
01 356
01 601
01 500
01 508
01 495
01 573

Universal busbar supports

Type	For busbars	Pack size	Weight kg/100	Price RM Each	Part no.
2-pole with internal screw holes	12, 20, 30 x 5, 10	1	8.3	81.20	01 602
3-pole with internal screw holes	12, 15, 20, 25, 30 x 5, 10	10	12.7	99.20	01 495
3-pole with additional external screw holes	12, 15, 20, 25, 30 x 5, 10	10	13.7	117.40	01 500
4-pole with internal screw holes	12, 15, 20, 25, 30 x 5, 10	10	26.6	144.00	01 485

UL busbar supports

3-pole with internal screw holes	12, 20, 30 x 5, 10	10	14.0	136.40	01 508
spacer, fits under 01 508		10	9.1	80.70	01 358
4-pole with internal screw holes	12, 20, 30 x 5, 10	10	19.7	199.20	01 357
spacer, fits under 01 357		10	13.1	104.90	01 359

base plate for UL busbar supports 01 508, 01 231, 01 232

Type	Pack size	Weight kg/100	Price RM Each	Part no.
240 x 1100	2	73.7	397.50	01 518
240 x 700	2	46.9	252.80	01 515

PE/N busbar supports, including PE and N labels

Type	For busbars	Pack size	Weight kg/100	Price RM Each	Part no.
2-pole, indiv. mountable	12, 15, 20, 25, 30 x 5, 10	10	9.5	94.80	01 356
1-pole, indiv. mountable	12, 20, 30 x 5, 10	1	5.9	59.10	01 601

Connection busbar support

3-pole, with integrated terminals 1.5 - 16 mm ²	12, 15, 20, 25, 30 x 5, 10	10	25.6	135.40	01 484
--	----------------------------	----	------	--------	--------

End cover, for covering busbar ends

Type	Pack size	Weight kg/100	Price RM Each	Part no.
for busbar support 01 602	1	1.5	18.50	01 363
for busbar supports 01 495, 01 500, 01 508 and 01 484	10	2.0	28.10	01 573
for busbar supports 01 357 and 01 485	5	5.6	74.70	01 131

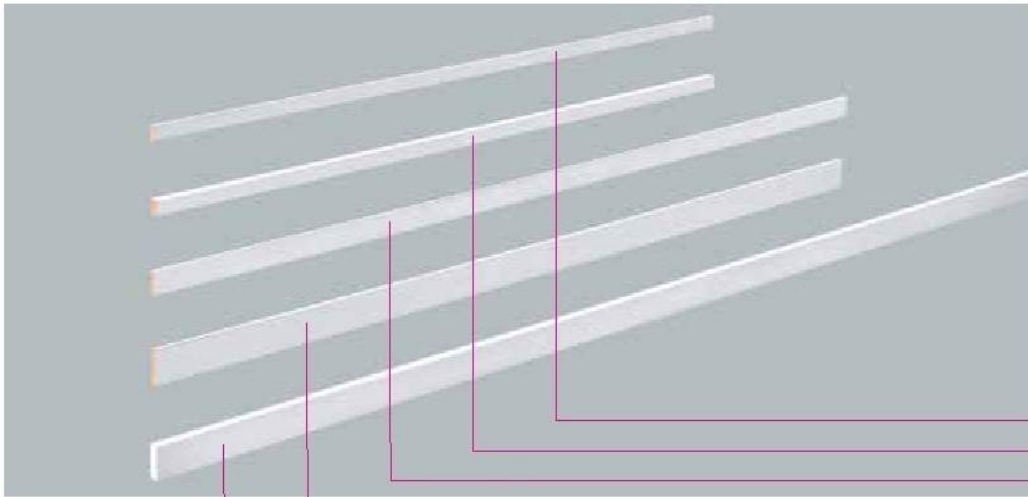

- 01 382
- 01 390
- 01 383
- 01 387
- 01 625

Busbar E-CU, flat busbars, tin-plated						
Type	Length mm	Cross section mm ²	Pack size	Weight kg/100	Price RM Each	Part no.
12 x 5	2400	60	1	128.2	TBA	01 618
	790	60	1	42.8	TBA	01 381
	590	60	1	32.0	TBA	01 382
15 x 5	2400	75	1	160.2	TBA	01 619
20 x 5	2400	100	1	213.6	TBA	01 620
	790	100	1	71.3	TBA	01 383
	590	100	1	53.4	TBA	01 384
25 x 5	2400	125	1	267.0	TBA	01 621
30 x 5	2400	150	1	320.4	TBA	01 622
	790	150	1	107.0	TBA	01 387
	590	150	1	80.1	TBA	01 388
12 x 10	2400	120	1	256.3	TBA	01 623
	790	120	1	85.6	TBA	01 389
	590	120	1	64.0	TBA	01 390
20 x 10	3600	200	1	650.0	TBA	01 140
	2400	200	1	427.2	TBA	01 624
	790	200	1	142.6	TBA	01 391
	590	200	1	106.8	TBA	01 392
30 x 10	3600	300	1	961.0	TBA	01 204
	2400	300	1	640.8	TBA	01 625
	790	300	1	214.0	TBA	01 393
	590	300	1	160.2	TBA	01 394

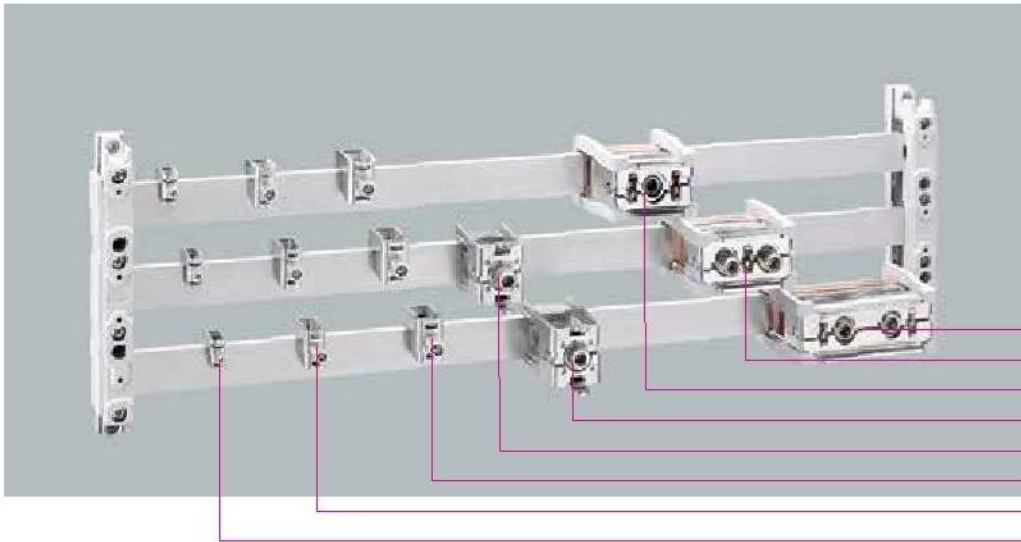

- 01 071
- 01 070
- 01 069
- 01 759
- 01 318
- 01 292
- 01 290
- 01 289

Universal conductor terminal

for busbars	Connection mm ² min. - max.	Terminal space W x H	For use up to max.	Pack size	Weight kg/100	Price RM Each	Part no.
5mm flat busbars	1.5 - 16	7.5 x 7.5	180A	100	2.1	7.20	01 284
	4 - 35	10.5 x 11	270A	50	4.6	10.60	01 285
	16 - 70	14 x 14	400A	25	7.1	14.20	01 287
	16 - 120	17 x 15	440A	25	10.6	33.20	01 068
10mm flat busbars	1.5 - 16	7.5 x 7.5	180A	100	2.3	11.60	01 289
	4 - 35	10.5 x 11	270A	50	4.7	16.80	01 290
10mm flat busbars, double-T and triple-T section	16 - 70	14 x 14	400A	25	7.5	19.50	01 292
	16 - 120	17 x 15	440A	25	10.9	33.20	01 203

CRITO®ProfClip, brace terminals

for busbars	Connection	For use up to max.	Pack size	Weight kg/100	Price RM Each	Part no.
20-30 x -10, double-T and triple-T section	for flat busbars up to 30 x 20	750A	6	30.3	120.30	01 319
	Cu and Al 95 - 185mm ² , rm, sm, f	500A	6	31.2	121.50	01 318
	for flat busbars up to 32 x 20	800A	3	34.7	164.20	01 759
	Cu and Al 120 - 300mm ² , rm, sm, f	600A	3	42.5	172.40	01 760

01 318 and 01 760: Not maintenance-free if aluminium conductors are used

CRITO®PowerClip, brace terminals for the connection of flat busbars and laminated copper

for busbars	Terminal space W x H	Side supply	Centre supply	Pack size	Weight kg/100	Price RM Each	Part no.
30 x -10 and double-T and triple-T section	55 x 10 - 28	1600A	2000A	3	50.0	516.80	01 069
	68 x 10 - 28	1600A	2000A	3	63.0	634.60	01 070
	105 x 10 - 28	1600A	2800A	3	84.0	967.70	01 071

Cover cap, 3-pole, can also be used as reserve section cover

Type W x H x D	for busbars	Pack size	Weight kg/100	Price RM Each	Part no.
54 x 200 x 55	12-30 x 5-10, double-T and triple-T section	1	14.7	98.40	01 590
84 x 200 x 55	12-30 x 5-10, double-T and triple-T section	10	14.9	107.80	01 413
135 x 200 x 90	20-30 x -10, double-T and triple-T section	1	29.5	153.20	01 756
180 x 200 x 90	12-30 x 5-10, double-T and triple-T section	1	33.0	255.90	01 539
228 x 200 x 90	12-30 x 5-10, double-T and triple-T section	1	37.3	278.70	01 596
250 x 200 x 90	12-30 x 5-10, double-T and triple-T section	1	39.3	289.20	01 540
270 x 200 x 90	20-30 x -10, double-T and triple-T section	1	64.7	217.50	01 757

Cover cap, 4-pole, can also be used as reserve section cover

228 x 260 x 90	12-30 x 5-10, double-T and triple-T section	1	45.0	342.00	01 597
----------------	---	---	------	--------	--------

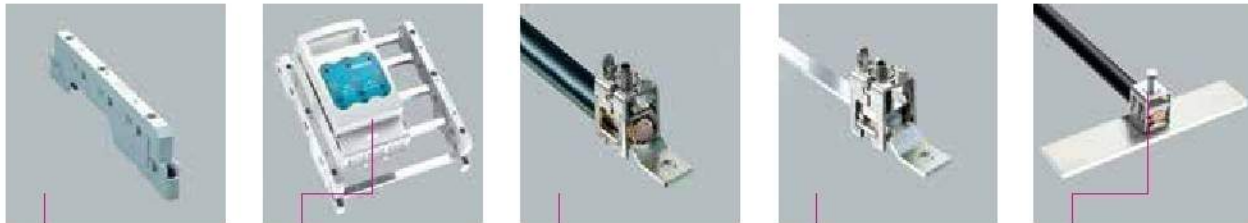

01 138	33 075	01 890	01 888	01 429
--------	--------	--------	--------	--------

Busbar support, 60mm-System, 3, 4, 5-pole, for VMS (GE) and AKI (Spelsberg) enclosure range						
Type	Pack size	Weight	Price RM Each	Part no.		
		kg/100				
for 3x (12, 20, 30 x 10) and 2x (12, 20, 25 x 5, 10) busbars	30	16.7	135.60	01 138		
Reducer, for 5mm busbars						
for 01 138	100	0.1	3.40	01 170		
3 units are required for one busbar support						
QUADRON®CrossLinkBreaker, NH bus-mounting fuse switch disconnecter, top/bottom connection, 3-pole with short connection module for 5-pole busbar systems, and distribution boards						
Type	Rated current	Size	Pack size	Weight	Price RM Each	Part no.
				kg/100		
box terminal	160A	NH00	1	100.0	TBA	33 075
connection screw M8	160A	NH00	1	100.0	TBA	33 079
connection screw M10	250A	NH1	1	357.0	TBA	33 194
Cover frame						
for ISO enclosure type VMS	10	16.6	125.30	01 139		
Reserve section cover, for use with cover frame 01 139 only						
54mm wide, pitch 3 x 18 mm	10	4.5	19.00	79 738		
variable 36 - 64 mm with 2 pieces	10	3.2	19.00	79 859		
Connector latch with brace terminal, for connecting equipment						
Busbars	For use	Pack size	Weight	Price RM Each	Part no.	
	up to max.		kg/100			
for flat busbars up to 30 x 20	630A	3	32.3	157.70	01 888	
for Cu and Al conductors 150 - 300 mm², rm, sm, f	* 600A	3	36.6	161.60	01 890	
* not maintenance-free if aluminium conductors are used (see page 8/2)						
FIBUS®, universal conductor terminal for drilled flat busbars						
6 - 240 mm², Cu and Al; re, rm, se and sm	630A	3	44.0	266.90	01 429	
current capacity of the terminal point with aluminium conductor 350A						



- 32 157
- 32 140
- 32 570
- 32 575

EQUES® PowerConnector

EQUES® PowerConnector, busbar adapter, 3-pole, phase division 23-30mm

Type	Rated current	adapter length	adapter width	SU	Weight kg/100	Price RM Each	Part no.
for Allen-Bradley 140U-H, top connection to system	160A	200	90	1	81.0	813.40	32 577
for ABB T-max T1, T-max T2, GE FD160, Schneider El. NS80, NSX80, top connection to system	160A	200	90	1	81.0	803.30	32 575
for Allen-Bradley 140-CMN, top connection to system	160A	200	90	1	81.0	803.30	32 549
for Eaton NZM1, with CrossLink® technology	160A	200	90	1	81.0	769.50	32 570
for Siemens S3, ABB MS49x, top connection to system	100A	200	72	1	66.0	500.70	32 981

EQUES® PowerConnector, busbar adapter, 3-pole, phase division 35-36mm

for ABB T-max T4, top connection to system	290A	240	105	1	122.0	687.90	32 601
for Allen-Bradley 140U-J	250A	192	106	1	90.0	681.90	32 137
for Schneider Electric NSX100-NSX250, GV7	250A	192	106	1	93.8	675.90	32 156
for Eaton NZM2-XKR40 and NZM2-XKR4U	250A	200	106	1	90.1	644.70	32 140
for Siemens 3VL1 UL	160A	192	108	1	95.3	902.20	32 976
for Siemens 3VL2, 3VL3 UL	250A	192	108	1	95.3	902.70	32 977
for Siemens 3VT250	250A	240	105	1	102.0	TBA	32 651
for Terasaki S250-NJ, top connection to system	250A	240	105	1	102.0	688.80	32 592

EQUES® PowerConnector, busbar adapter, 3-pole, phase division 43-45mm

for ABB T-max T5	580A	300	140	1	252.0	1443.60	32 593
for Allen-Bradley 140U-L	600A	272	140	1	212.0	1299.36	32 138
for Schneider Electric NS400/630, NSX 400/630	570A	272	140	1	222.6	1300.40	32 157
for Eaton NZM3-XKR130 and NZM3-XKR13U	630A	300	140	1	250.0	1336.80	32 978
for Siemens 3VL4	400A	295	140	1	222.4	1647.40	32 975
for Siemens 3VT630	600A	300	140	1	250.0	1336.80	32 641

EQUES® PowerConnector, busbar adapter, 3-pole, phase division 63mm, top connection

for Siemens 3VL5	580A	325	184	1	276.0	2461.00	32 980
------------------	------	-----	-----	---	-------	---------	--------

all adapters for 12, 15, 20, 25, 30 x 5, 10mm busbars, double-T and triple-T section.

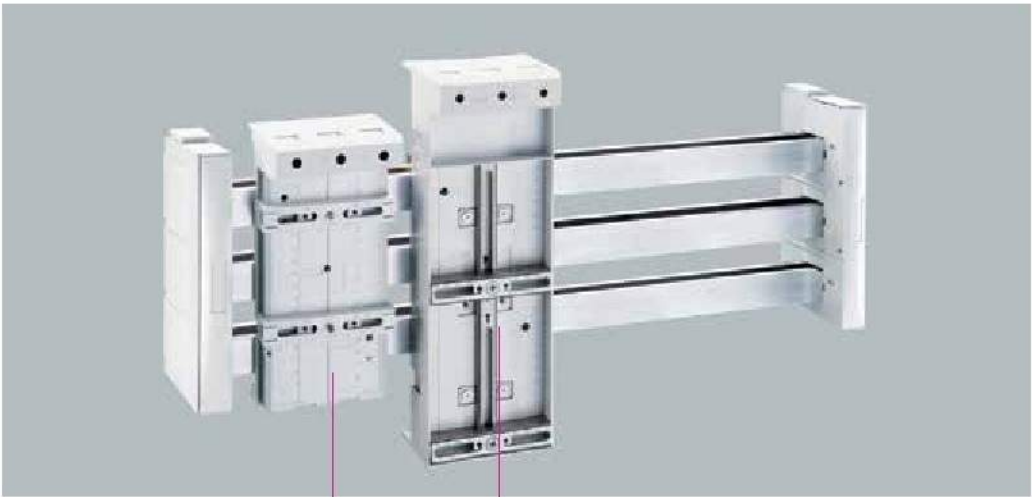

32 168

32 214

Universal busbar adapter

Type	adapter length	adapter width	Pack size	Weight kg/100	Price RM Each	Part no.
200A top connection to system	222	108	1	84.2	488.00	32 214
200A bottom connection to system	222	108	1	86.0	488.00	32 215
250A top connection to system	320	110	1	160.4	550.80	32 168
250A bottom connection to system	320	110	1	164.0	550.80	32 216
for all commercially available switchgear with M4 fixing screws (see accessories for M5 screws)						

Accessories for universal busbar adapters

M5 slide nut for 32 214, 32 215, 32 168 and 32 216			4	0.4	5.10	32 937
--	--	--	---	-----	------	--------

Busbar adapter 630A

screw M10 top or bottom	320	184	1	278.0	1117.20	32 004
metal accessory plate, without drillings	315	180	1	0.0	357.90	32 911

all adapters for 12, 15, 20, 25, 30 x 5 - 10mm busbars, double-T and triple-T section.

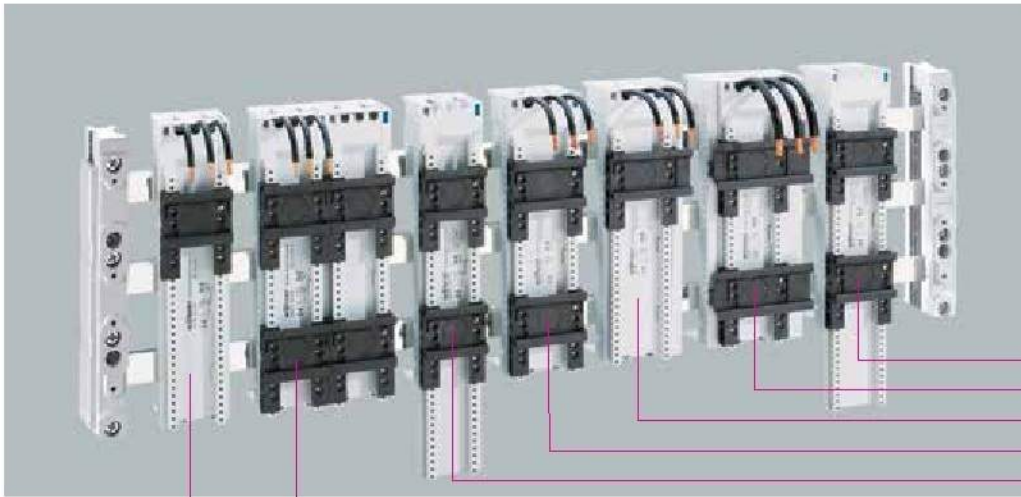

- 32 472
- 32 459
- 32 443
- 32 442
- 32 439
- 32 432
- 32 430

EQUES® EasyConnector

EQUES® EasyConnector 25A, busbar adapter with leads AWG 12 (4mm²)

Type	adapter width	adapter length	Pack size	Weight kg/100	Price RM Each	Part no.
1 mounting rail	45	200	4	32.5	178.60	32 430
2 mounting rails	45	200	4	32.6	189.40	32 431
2 mounting rails	90	200	2	57.1	364.10	32 432
2 mounting rails	45	260	4	35.7	229.50	32 433

EQUES® EasyConnector 25A, busbar adapter with 6mm² connection terminals, without leads

2 mounting rails	45	200	4	32.2	182.20	32 436
2 mounting rails	45	260	4	35.2	215.30	32 439
UL terminal cap for 32 436 and 32 439	38	15	4	0.7	58.80	32 973

EQUES® EasyConnector 32A, busbar adapter with leads AWG 10 (6mm²)

1 mounting rail	45	200	4	33.3	202.80	32 655
1 mounting rail	54	200	4	36.6	213.90	32 441
2 mounting rails	54	200	4	38.0	224.90	32 442
1 mounting rail	63	200	4	44.5	265.50	32 443
1 mounting rail	72	200	4	44.3	293.10	32 444
2 mounting rails	81	200	4	49.5	332.90	32 446
2 mounting rails	54	260	4	43.3	271.50	32 449

EQUES® EasyConnector 63A, busbar adapter with leads AWG 8 (10mm²)

1 mounting rail	54	200	4	39.2	247.00	32 454
2 mounting rails	54	200	4	41.0	259.50	32 455
1 mounting rail	63	200	4	44.9	280.80	32 456
1 mounting rail	72	200	4	47.6	306.30	32 457
2 mounting rails	81	200	4	51.3	346.80	32 459
2 mounting rails	54	260	4	43.0	296.00	32 461

EQUES® EasyConnector 80A, busbar adapter with 16mm² connection terminals, without leads

1 mounting rail	54	200	4	37.3	254.70	32 466
2 mounting rails	54	200	4	38.9	267.40	32 467
1 mounting rail	72	200	4	45.0	309.90	32 469
2 mounting rails	54	260	4	43.8	312.00	32 472
UL terminal cap for 32 466, 32 467, 32 469 and 32 472	47	15	4	0.8	67.20	32 974

all adapters for 12, 15, 20, 25, 30 x 5, 10mm busbars, double-T and triple-T section.



33 063
33 602
33 601

QUADRON®CrossLinkBreaker NH size 000 to 3, NH bus-mounting fuse switch disconnecter, bottom/top connection, 3-pole

Type	Rated current	Size	Pack size	Weight kg/100	Price RM Each	Part no.
box terminal	125A	NH000	1	113.0	595.50	33 216
box terminal	160A	NH00	1	100.0	614.90	33 198
connection screw M8	160A	NH00	1	103.0	614.00	33 398
box terminal	250A	NH1	1	266.0	2167.50	33 600
connection screw M10	250A	NH1	1	266.0	1879.20	33 601
connection screw M10	400A	NH2	1	522.0	2570.70	33 602
connection screw M12	630A	NH3	1	756.0	3825.20	33 603

QUADRON®CrossLinkBreaker NH size 00 to 3, NH bus-mounting fuse switch disconnecter, bottom/top connection, 3-pole with electronic fuse monitoring

box terminal, electronic fuse monitoring	160A	NH00	1	117.0	2153.10	33 324
connection screw M8	160A	NH00	1	117.0	2151.90	33 394
connection screw M10	250A	NH1	1	223.0	3509.30	33 325
connection screw M10	400A	NH2	1	572.0	4341.60	33 326
connection screw M12	630A	NH3	1	796.0	5632.80	33 327

QUADRON®CrossLinkBreaker NH size 00 to 3, NH bus-mounting fuse switch disconnecter, bottom/top connection, 3-pole with electro-mechanical fuse monitoring

box terminal	160A	NH00	1	180.0	2549.30	33 206
connection screw M8	160A	NH00	1	180.0	2548.60	33 420
connection screw M10	250A	NH1	1	333.0	3871.50	33 160
connection screw M10	400A	NH2	1	574.0	4702.80	33 161
connection screw M12	630A	NH3	1	824.0	6036.80	33 162
circuit diagram for fuse monitoring on page 9/40						

Conversion kit

for 5mm busbars	2	1	6.5	141.20	33 148
for mounting on 12, 15, 20, 25 and 30 x 5 mm busbars for QUADRON®CrossLinkBreaker size 2					

devices can be connected directly to 12, 15, 20, 25, 30 x 5, 10mm busbars, double-T and triple-T section.
conversion kit 33 148 is required for mounting size 2 onto 5mm busbars,
size 3 is not suitable for 5mm busbars.
NH bus-mounting fuse switch disconnectors size 00 and 1 with short connection module for 5-pole busbar systems,
service distribution board, insulated distribution board see page 2/20 and 7/3

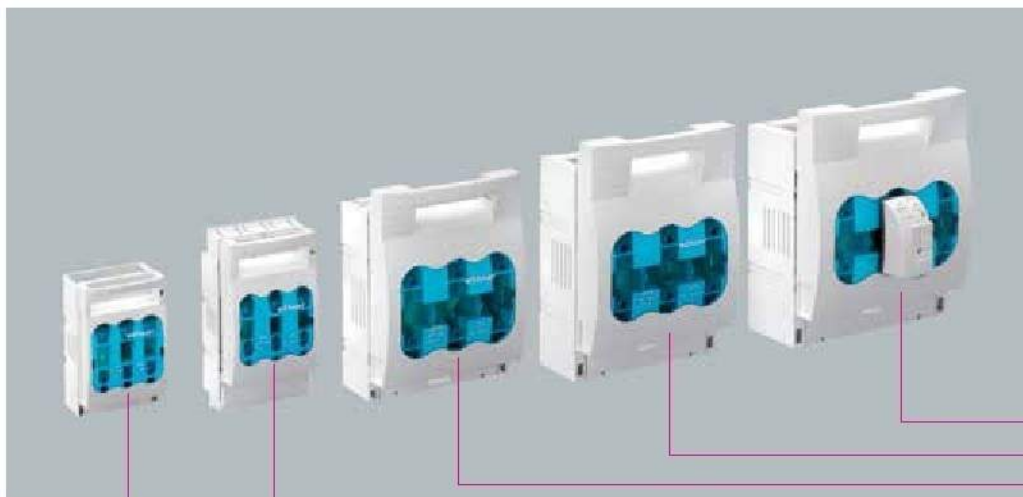

33 332
33 202
33 201
33 199
33 217

QUADRON®CrossLinkBreaker

NH fuse switch disconnecter for panel-mounting

QUADRON®CrossLinkBreaker size 000 to 3, NH fuse switch disconnecter

Type	Rated current	Size	Pack size	Weight kg/100	Price RM Each	Part no.
box terminal	125A	NH000	1	57.2	425.60	33 217
clamp	160A	NH00	1	78.0	477.40	33 199
screw M8	160A	NH00	1	77.7	477.40	33 200
box terminal	250A	NH1	1	191.0	1740.80	33 393
screw M10	250A	NH1	1	171.0	1157.80	33 201
screw M10	400A	NH2	1	362.0	1867.70	33 202
screw M10	630A	NH3	1	490.0	2397.40	33 203

QUADRON®VolBreaker size 4a, NH fuse switch disconnecter

2 x screw M12	1600A	NH4a	1	1534.0	13363.20	33 204
---------------	-------	------	---	--------	----------	--------

QUADRON®CrossLinkBreaker size 00, NH fuse switch disconnecter, shortened shock protection

clamp 70mm²	160A	NH00	1	71.6	477.40	33 221
screw M8	160A	NH00	1	71.9	477.40	33 222

QUADRON®CrossLinkBreaker size 00 to 3, NH fuse switch disconnecter, with electronic fuse monitoring

clamp 70mm²	160A	NH00	1	93.0	2017.50	33 328
screw M8	160A	NH00	1	92.0	2017.50	33 329
screw M10	250A	NH1	1	229.0	2759.10	33 330
screw M10	400A	NH2	1	380.0	3605.80	33 331
screw M12	630A	NH3	1	524.0	4165.50	33 332

QUADRON®CrossLinkBreaker size 00 to 3, NH fuse switch disconnecter, with electromechanical fuse monitoring

clamp 70mm²	160A	NH00	1	127.0	2454.80	33 207
screw M8	160A	NH00	1	126.0	2454.80	33 208
screw M10	250A	NH1	1	255.0	3127.70	33 149
screw M10	400A	NH2	1	412.0	4067.30	33 150
screw M12	630A	NH3	1	556.0	4615.70	33 151

circuit diagram for fuse monitoring on page 9/40

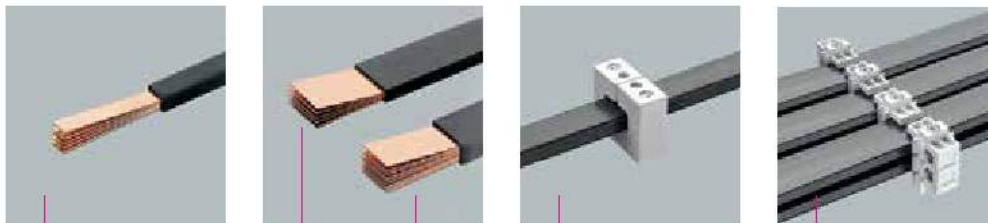

01 196	01 612	01 613	01 298	01 299
--------	--------	--------	--------	--------

Laminated copper busbars, plain, insulated (105°C), length 2m

Dimensions	Rated current	Cross section	Pack size	Weight *	Price RM Each	Part no.
	50K	mm ²		kg/100		
3 x 9 x 0.8	162A	21.6	1	38.4	320.00	01 054
6 x 9 x 0.8	240A	43.2	1	76.9	428.00	01 194
4 x 13 x 0.5	190A	26	1	46.3	327.00	01 322
6 x 13 x 0.5	237A	39	1	69.4	410.00	01 050
10 x 13 x 0.5	316A	65	1	115.7	571.00	01 418
4 x 15.5 x 0.8	279A	49.6	1	88.3	487.00	01 196
6 x 15.5 x 0.8	350A	74.4	1	132.4	636.00	01 035
10 x 15.5 x 0.8	470A	124	1	220.7	940.00	01 583
3 x 20 x 1	326A	60	1	106.8	570.00	01 027
6 x 20 x 1	477A	120	1	213.6	980.00	01 028
10 x 20 x 1	640A	200	1	356.0	1876.00	01 029
4 x 24 x 1	438A	96	1	170.9	793.00	01 253
5 x 24 x 1	495A	120	1	213.6	980.00	01 611
6 x 24 x 1	547A	144	1	256.3	1188.00	01 255
8 x 24 x 1	641A	192	1	341.8	1596.00	01 323
10 x 24 x 1	727A	240	1	427.2	1971.00	01 184
5 x 32 x 1	617A	160	1	284.8	1467.00	01 612
10 x 32 x 1	894A	320	1	569.6	2674.00	01 613
5 x 40 x 1	736A	200	1	356.0	1783.00	01 614
6 x 40 x 1	809A	240	1	427.2	2053.00	01 256
10 x 40 x 1	1053A	400	1	712.0	3137.00	01 615
5 x 50 x 1	880A	250	1	445.0	2258.00	01 060
8 x 50 x 1	1114A	400	1	712.0	3280.00	01 343
10 x 50 x 1	1244A	500	1	890.0	3992.00	01 509
5 x 63 x 1	1061A	315	1	560.7	3868.00	01 324
10 x 63 x 1	1481A	630	1	1121.4	5076.00	01 510
10 x 80 x 1	1777A	800	1	1424.0	6215.00	01 061
10 x 100 x 1	2110A	1000	1	1780.0	8182.00	01 273

* the weight specified is the pure copper weight, it does not include the weight of the insulation.

Holder, for laminated busbars

Type	Pack size	Weight	Price RM Each	Part no.
		kg/100		
for 1x lam. Cu from 6 x 15.5 x 0.8 to 10 x 100 x 1	*	3	TBA	01 298
for multiple fixing of lam. Cu from 5 x 40 x 1 to 10 x 100 x 1	*	4	TBA	01 299

* start of delivery on request

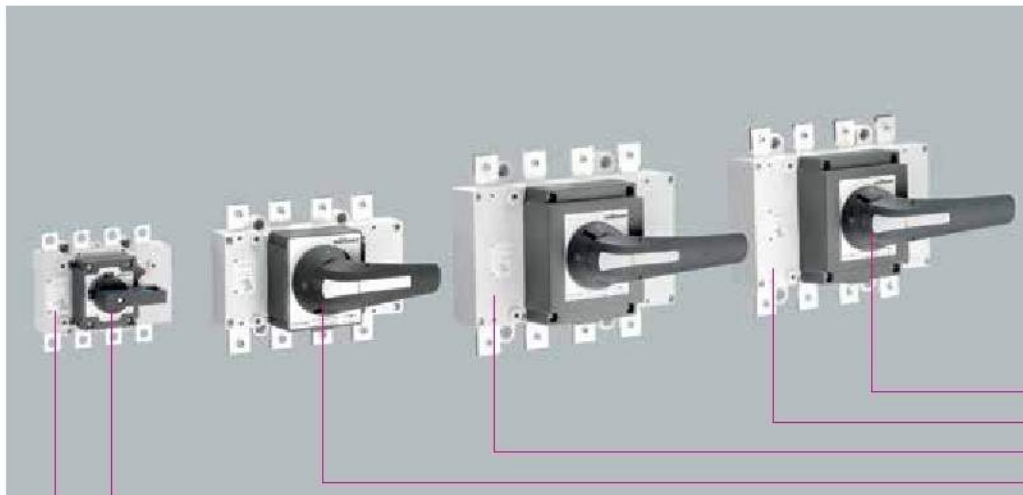

- 33 928
- 33 449
- 33 448
- 33 447
- 33 296
- 33 441

CAPUS® EasyUse

CAPUS® EasyUse, switch disconnecter 3-pole, 3-pole switching, 400V AC, without handle

Type	Rated current	Pack size	Weight kg/100	Price RM Each	Part no.
box terminal 95mm ²	125A	1	80.0	TBA	33 424
screw M8	125A	1	80.0	TBA	33 425
box terminal 95mm ²	160A	1	80.0	TBA	33 426
screw M8	160A	1	80.0	TBA	33 427
screw M10	200A	1	80.0	TBA	33 428
screw M10	250A	1	90.0	TBA	33 429
screw M10	315A	1	170.0	TBA	33 430
screw M10	400A	1	170.0	TBA	33 431
screw M10	630A	1	420.0	TBA	33 432
screw M10	800A	1	420.0	TBA	33 433
screw M14	* 1250A	1	700.0	TBA	33 434
screw M14	* 1600A	1	1850.0	TBA	33 435
screw M14	* 1800A	1	1850.0	TBA	33 436
screw M12	* 2000A	1	5500.0	TBA	33 437
screw M12	* 2500A	1	5500.0	TBA	33 438
screw M12	* 3150A	1	5600.0	TBA	33 439
* lead time on request					

CAPUS® EasyUse, switch disconnecter 3-pole+N, 4-pole switching, 400V AC, without handle

box terminal 95mm ²	125A	1	90.0	TBA	33 440
screw M8	125A	1	90.0	TBA	33 441
box terminal 95mm ²	160A	1	90.0	TBA	33 442
screw M8	160A	1	90.0	TBA	33 443
screw M10	200A	1	90.0	TBA	33 444
screw M10	250A	1	100.0	TBA	33 445
screw M10	315A	1	190.0	TBA	33 446
screw M10	400A	1	190.0	TBA	33 447
screw M10	630A	1	450.0	TBA	33 448
screw M10	800A	1	450.0	TBA	33 449
screw M14	* 1250A	1	760.0	TBA	33 450
screw M14	* 1600A	1	2100.0	TBA	33 451
screw M12	* 2000A	1	7500.0	TBA	33 452
screw M12	* 2500A	1	7500.0	TBA	33 453
screw M12	* 3150A	1	7600.0	TBA	33 454
* lead time on request					

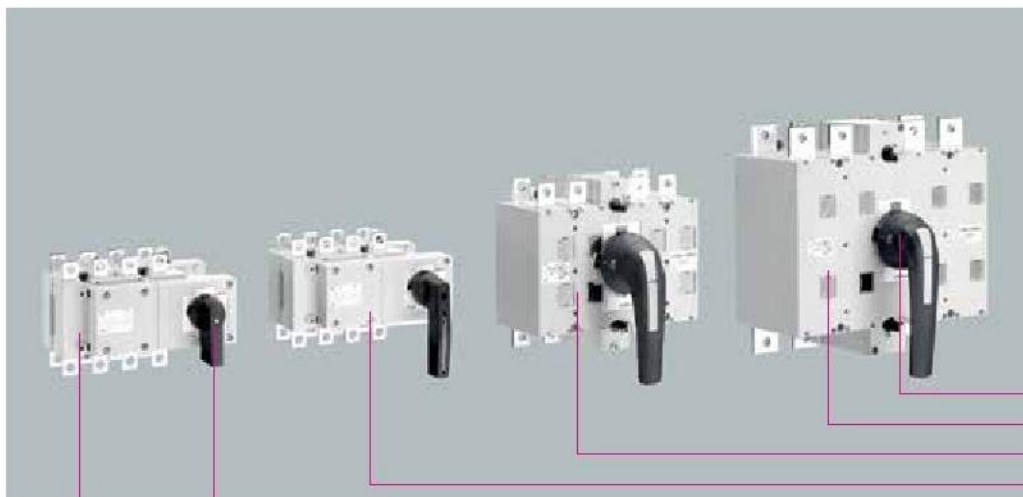

33 937
33 470
33 467
33 465
33 935
33 464

CAPUS® EasyUse

CAPUS® EasyUse, change over switches 3-pole, 3-pole switching, 400V AC, without handle

Type	Rated current	Pack size	Weight kg/100	Price RM Each	Part no.
screw M8	125A	1	180.0	TBA	33 455
screw M8	160A	1	180.0	TBA	33 456
screw M10	200A	1	190.0	TBA	33 457
screw M10	250A	1	550.0	TBA	33 458
screw M10	315A	1	550.0	TBA	33 459
screw M10	400A	1	550.0	TBA	33 460
screw M12	630A	1	1260.0	TBA	33 461
screw M12	800A	1	1260.0	TBA	33 462
screw M14	1000A	1	2430.0	TBA	33 463

CAPUS® EasyUse, change over switches 3-pole+N, 4-pole switching, 400V AC, without handle

Type	Rated current	Pack size	Weight kg/100	Price RM Each	Part no.
screw M8	125A	1	210.0	TBA	33 464
screw M8	160A	1	210.0	TBA	33 465
screw M10	200A	1	220.0	TBA	33 466
screw M10	250A	1	590.0	TBA	33 467
screw M10	315A	1	590.0	TBA	33 468
screw M10	400A	1	590.0	TBA	33 469
screw M12	630A	1	1370.0	TBA	33 470
screw M12	800A	1	1370.0	TBA	33 471
screw M14	1000A	1	2680.0	TBA	33 472



36 111
36 112
36 110
36 114
36 109
36 113

MOTUS® ContactronControl

Spare components

Type	Pack size	Weight kg/100	Price RM Each	Part no.
16A fuse for 0.6A and 2.4A versions	3	2.8	159.20	31 567
20A fuse for 9A version	3	2.8	159.20	31 568
30A fuse for 9A version for motors with heavy starting	3	2.8	159.20	31 569
0.075 - 0.6A electronics module for direct/reversing starters	1	57.1	1688.40	36 109
0.18 - 2.4A electronics module for direct/reversing starters	1	57.1	1688.40	36 110
1.5 - 9A electronics module for direct/reversing starters	1	57.1	1688.40	36 111
adapter for 60mm-System compact	1	9.3	137.30	36 113
adapter for 60mm-System classic	1	11.0	146.40	36 114
adapter for 60mm-System compact	1	12.8	174.80	36 112

Accessories, for DIN rail model

Type	Pack size	Weight kg/100	Price RM Each	Part no.
plug connector with cable connection, 2 devices	1	7.6	122.40	36 902
plug connector with cable connection, 3 devices	1	9.0	164.90	36 903
plug connector with cable connection, 4 devices	1	10.9	205.50	36 904

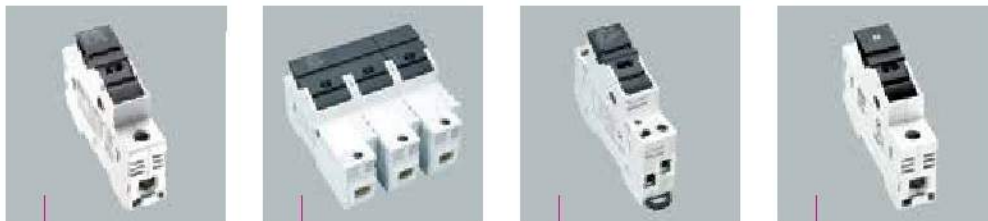

31 110	31 123	31 273	31 258
--------	--------	--------	--------

AMBUS® EasySwitch

Holders for cylindrical fuses

with box terminals, snap-in mounting, shock protection in accordance with DIN 50274

AMBUS® EasySwitch, holder for cylindrical fuses, standard model, without neutral conductor

Size	Rated current	Type	Width mm	Connection mm ²	Pack size	Weight kg/100	Price RM Each	Part no.
10x38	32A	1-pole	18	0.75 - 25mm ² / AWG 18 - 4	12	5.2	46.10	31 110
		2-pole	36	0.75 - 25mm ² / AWG 18 - 4	6	10.3	92.40	31 112
		3-pole	54	0.75 - 25mm ² / AWG 18 - 4	4	15.5	138.50	31 113
14x51	50A	1-pole	27	1.5 - 35mm ² / AWG 14 - 2	6	9.7	148.40	31 115
		2-pole	54	1.5 - 35mm ² / AWG 14 - 2	3	20.2	296.20	31 117
		3-pole	81	1.5 - 35mm ² / AWG 14 - 2	2	30.4	444.50	31 118
22x58	100A	1-pole	36	4 - 50mm ² / AWG 10 - 1/0	6	15.8	212.90	31 120
		2-pole	72	4 - 50mm ² / AWG 10 - 1/0	3	32.2	425.60	31 122
		3-pole	108	4 - 50mm ² / AWG 10 - 1/0	2	48.6	638.70	31 123

AMBUS® EasySwitch, holder for cylindrical fuses, standard model, neutral conductor on the right

10x38	32A	1-pole+N	36	0.75 - 25mm ² / AWG 18 - 4	6	11.3	97.50	31 111
		3-pole+N	72	0.75 - 25mm ² / AWG 18 - 4	3	21.7	189.90	31 114
14x51	50A	1-pole+N	54	1.5 - 35mm ² / AWG 14 - 2	3	21.8	318.90	31 116
		3-pole+N	108	1.5 - 35mm ² / AWG 14 - 2	1	42.7	627.40	31 119
22x58	100A	1-pole+N	72	4 - 50mm ² / AWG 10 - 1/0	3	35.8	457.20	31 121
		3-pole+N	144	4 - 50mm ² / AWG 10 - 1/0	1	67.5	882.80	31 124

AMBUS® EasySwitch, holder for cylindrical fuses, standard model, neutral conductor on the left

14x51	50A	3-pole+N	108	1.5 - 35mm ² / AWG 14 - 2	1	42.7	627.40	31 168
22x58	100A	3-pole+N	144	4 - 50mm ² / AWG 10 - 1/0	1	67.5	882.80	31 171

AMBUS® EasySwitch, holder for cylindrical fuses, N-module

10x38	32A	N	18	0.75 - 25mm ² / AWG 18 - 4	12	6.2	51.20	31 258
-------	-----	---	----	---------------------------------------	----	-----	-------	--------

AMBUS® EasySwitch, holder for cylindrical fuses, standard model, with integrated neutral conductor (on the left)

10x38	32A	1-pole+N	18	1.5 - 10mm ²	12	9.0	96.30	31 273
		3-pole+N	54	1.5 - 10mm ²	4	22.0	109.20	31 274

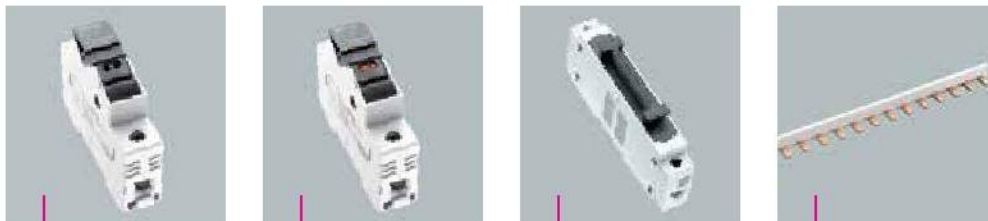

31 971	31 973	31 555	31 548
--------	--------	--------	--------

AMBUS® EasySwitch for photovoltaics

Holders for cylindrical fuses

with box terminals, shock protection in accordance with DIN 50274

AMBUS® EasySwitch, holder for cylindrical fuses, **photovoltaic version**, for DIN rails

Size	Rated current	Type	Width	Connection	Pack size	Weight	Price RM Each	Part no.
	Rated voltage		mm			kg/100		
10x38	30A / 1000V DC	1-pole	18	0.75 - 25mm ² / AWG 18 - 4	12	5.2	51.90	31 971
10x38	* 30A / 1000V DC	1-pole, with LED	18	0.75 - 25mm ² / AWG 18 - 4	12	5.7	90.30	31 973
10x38	30A / 1000V DC	2-pole	36	0.75 - 25mm ² / AWG 18 - 4	6	10.3	TBA	31 974
10x85	** 25A / 1500V DC	1-pole	23	0.75 - 25mm ² / AWG 18 - 4	5	9.2	122.90	31 555

For fuse links, see page 5/2

* LED indicates blown fuse, operating range 400-1000V

** also suitable for 14 x 85 fuses

Comb-type busbar, 1000V DC, length 1m

Type	Supply centre	Supply side	Cross section	Pack size	Weight	Price RM Each	Part no.
			mm ²		kg/100		
1-pole, insulated, bridge, for 31 971 and 31 973, pitch 18mm	130A	80A	16	25	21.8	166.40	31 101
	200A	100A	25	10	47.5	283.20	31 548
1-pole, insulated, bridge, for 31 971, 31 973 and 31 555, pitch 27mm	130A	80A	16	25	19.0	168.30	31 014
	220A	130A	35	10	50.0	414.30	31 057

Connecting terminal, for comb-type busbars

Type	Pack size	Weight	Price RM Each	Part no.
		kg/100		
for 31 014, side connection up to 50mm ²	25	2.5	51.90	31 028
for 31 057, side connection up to 95mm ²	3	9.0	129.60	01 198
for 31 101, side connection up to 25mm ²	50	1.2	27.60	31 103
for 31 101, front connection up to 25mm ²	50	1.2	30.50	31 157
for 31 548, front connection up to 35mm ²	10	3.5	45.60	31 550

End cap, for comb-type busbars

Type	Pack size	Weight	Price RM Each	Part no.
		kg/100		
for 31 548	10	0.1	TBA	31 566

4.5mm spacer, set for 50 fuse holders

for 31 971 and 31 973, permits arrangement in 22.5mm pitch	1	1.2	TBA	31 563
--	---	-----	-----	--------

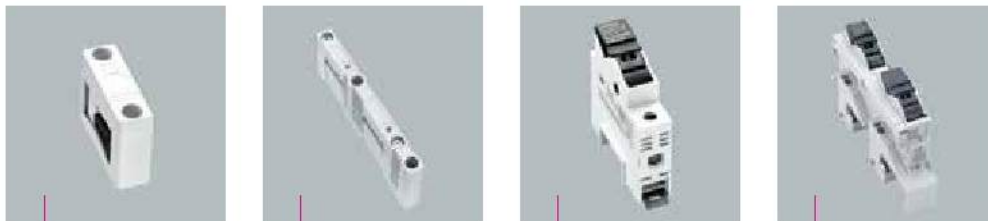

01 601	01 602	31 570	31 956
--------	--------	--------	--------

AMBUS® EasyLiner for photovoltaics

AMBUS® EasyLiner, bus-mounting fuse base, 1000V DC

Type	Rated current	Pole	Pack size	Weight kg/100	Price RM Each	Part no.
for fuses 10 x 38 IEC 60 269-6 *	30A	1-pole	12	5.0	58.60	31 572
for fuses 10 x 38 IEC 60 269-6 **	30A	1-pole	12	5.0	58.60	31 570
for fuses 10 x 38 IEC 60 269-6 ***	20A	2-pole	6	12.2	309.20	31 956
for fuses 10 x 38 IEC 60 269-2 with LED 400-1000V AC/DC ***	20A	2-pole	6	12.2	TBA	31 960
* for busbars 20 x 5, 10						
** for busbars 30 x 5, 10						
*** for 12, 15, 20, 25 and 30 x 5 or 10 busbars						

Universal busbar supports

Type	Busbars	Pack size	Weight kg/100	Price RM Each	Part no.
1-pole, indiv. mountable	12, 20, 30 x 5, 10	1	5.9	59.10	01 601
2-pole with internal screw holes	12, 20, 30 x 5, 10	1	8.3	81.20	01 602
for terminals for busbars see pages 2/7 to 2/9					

Cover cap

Type	Pack size	Weight kg/100	Price RM Each	Part no.
for fixing to busbar support 01 602	1	5.3	248.00	01 536

Fuse link gPV, as per IEC/EN 60 269-6, for photovoltaic applications

Size	Rated current	Rated voltage	Power output	Pack size	Weight kg/100	Price RM Each	Part no.
10x38	8A	1000V	1.6W	10	0.6	142.10	31 543
	10A	1000V	2W	10	0.6	142.10	31 544
	12A	1000V	2.4W	10	0.6	142.10	31 545
	16A	1000V	2.1W	10	0.6	142.10	31 546
	20A	1000V	2.5W	10	0.6	142.10	31 547
14x85	16A	1100V	3.8W	20	2.7	228.50	31 560
	20A	1100V	4.7W	20	2.7	228.50	31 559
	25A	1000V	5.9W	20	2.7	228.50	31 558

Kabelverschraubungen Syntec® Kunststoff mit Lamellentechnik

Kurzes Anschlussgewinde metrisch

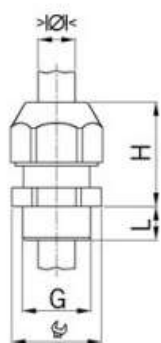

Material: Polyamid PA 6
 Dichtring: TPE oder CR (Neopren)
 Geprüft nach: EN 50262
 Einsatztemperatur: -30°C / +100°C
 Schutzart: IP 68

Synthetic cable glands Syntec® with lamellar technology

Short entry thread metric

Material: Polyamide PA 6
 Sealing ring: TPE or CR (Neoprene)
 Tested acc. to: EN 50262
 Temperature range: -30°C / +100°C
 Protection class: IP 68

SYNTEC



Hellgrau RAL 7035
Einteiliger Dichtring

Light grey RAL 7035
One-piece sealing ring

Art.-Nr.	G	>Ø< mm	mm	H mm	L mm		Price RM Each
1555.12.06	M12x1.5	2.5-6.5	15	21	6	100	3.10
1555.17.10	M16x1.5	4.5-10.0	19	25	8	50	3.10
1555.20.13	M20x1.5	7.0-13.0	24	29	9	50	4.00
1555.25.17	M25x1.5	10.0-17.0	29	38	10	25	6.00
1555.32.25	M32x1.5	17.0-25.0	42	36	10	20	10.00
1555.40.1.33	M40x1.5	22.0-33.0	53	48	15	10	22.00
1555.50.1.38	M50x1.5	28.0-38.0	60	48	15	5	34.00
1555.63.1.44	M63x1.5	32.0-44.0	65	49	16	5	40.00



Kabelverschraubungen Syntec® Kunststoff mit Lamellentechnik

Anschlussgewinde Pg

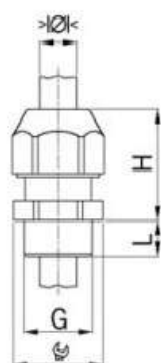

Material: Polyamid PA 6
 Dichtring: CR (Neopren)
 Einsatztemperatur: -30°C / +100°C
 Schutzart: IP 68

Synthetic cable glands Syntec® with lamellar technology

Entry thread Pg

Material: Polyamide PA 6
 Sealing ring: CR (neoprene)
 Temperature range: -30°C / +100°C
 Protection class: IP 68

SYNTEC



Hellgrau RAL 7035
Einteiliger Dichtring

Light grey RAL 7035
One-piece sealing ring

Art.-Nr.	G	>Ø< mm	mm	H mm	L mm		Price RM Each
1555.07.06	Pg 7	2.5-6.5	15	21	8	100	3.00
1555.09.08	Pg 9	3.0-8.0	19	23	8	50	3.50
1555.11.07	Pg 11	2.0-7.0	22	25	8	50	4.00
1555.11.10	Pg 11	4.0-10.0	22	25	8	50	4.00
1555.13.07	Pg 13	3.0-7.0	24	26	9	50	4.50
1555.13.12	Pg 13	5.5-12.0	24	26	9	50	4.50
1555.16.11	Pg 16	5.0-11.0	27	30	10	50	5.50
1555.16.14	Pg 16	8.5-14.0	27	30	10	50	5.50
1555.21.14	Pg 21	6.5-14.0	33	35	11	25	8.50
1555.21.18	Pg 21	11.0-18.0	33	35	11	25	8.50
1555.29.25	Pg 29	17.0-25.0	42	36	11	20	11.00
1555.36.33	Pg 36	22.0-33.0	53	48	15	10	28.00
1555.42.38	Pg 42	28.0-38.0	60	48	15	5	39.00
1555.48.44	Pg 48	32.0-44.0	65	48	15	5	42.00



Kabelverschraubungen Progress® Messing

Kurzes Anschlussgewinde metrisch

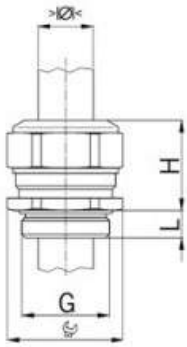

Material: Messing vernickelt
 Dichtung: TPE / NBR
 O-Ring : NBR
 Zugentlastung: Nach EN 50262 Ausführung A
 Einsatztemperatur: -40°C / +100°C
 Schutzart: IP 68

Cable glands Progress®

nickel-plated brass

Short entry thread metric

Material: Nickel-plated brass
 Seal: TPE / NBR
 O-ring : NBR
 Strain relief: Acc. to EN 50262 version A
 Temperature range: -40°C / +100°C
 Protection class: IP 68

Progress MS



**Einteiliger Dichtungseinsatz
 nicht durchgehend isolierend**

**One-piece sealing insert
 not overall length insulated**



Art.-Nr.	G	>Ø< mm	mm	H mm	L mm		Price RM Each
1000.06.025	M 6x1.0 ¹⁾	2.0-2.5	8	12	5	50	TBA
1000.06.030	M 6x1.0 ¹⁾	2.5-3.0	8	12	5	50	TBA
1000.06.035	M 6x1.0 ¹⁾	3.0-3.5	8	12	5	50	TBA
1000.08.035	M 8x1.25 ¹⁾	2.5-3.5	11	14	5	50	TBA
1000.08.050	M 8x1.25 ¹⁾	3.5-5.0	11	14	5	50	TBA
1000.10.040	M10x1.5 ¹⁾	3.0-4.0	13	15	5	50	TBA
1000.10.060	M10x1.5 ¹⁾	4.0-6.0	13	15	5	50	TBA
1000.12.050	M12x1.5	3.5-5.0	15	17	5	50	TBA
1000.12.065	M12x1.5	5.0-6.5	15	17	5	50	TBA
1000.12.080	M12x1.5	6.5-8.0	15	17	5	50	TBA
1000.17.045	M16x1.5	3.5-4.5	18	20	5	50	TBA
1000.17.060	M16x1.5	4.5-6.0	18	20	5	50	TBA
1000.17.080	M16x1.5	6.0-8.0	18	20	5	50	TBA
1000.17.105	M16x1.5	8.0-10.5	18	22	5	50	TBA
1000.20.080	M20x1.5	6.0-8.0	24	21	6	50	TBA
1000.20.110	M20x1.5	8.0-11.0	24	21	6	50	TBA
1000.20.150	M20x1.5	11.0-15.0	24	23	6	50	TBA
1000.25.125	M25x1.5	9.5-12.5	30	25	7	25	TBA
1000.25.160	M25x1.5	12.5-16.0	30	25	7	25	TBA
1000.25.205	M25x1.5	16.0-20.5	30	28	7	25	TBA
1000.32.170	M32x1.5	14.0-17.0	36	28	8	25	TBA
1000.32.210	M32x1.5	17.0-21.0	36	28	8	25	TBA
1000.32.255	M32x1.5	21.0-25.5	36	28	8	25	TBA
1000.40.240	M40x1.5	20.0-24.0	46	31	8	10	TBA
1000.40.285	M40x1.5	24.0-28.5	46	31	8	10	TBA
1000.40.330	M40x1.5	28.5-33.0	46	31	8	10	TBA
1000.50.330	M50x1.5	29.0-33.0	55	34	9	10	TBA
1000.50.370	M50x1.5	33.0-37.0	55	34	9	10	TBA
1000.50.420	M50x1.5	37.0-42.0	55	34	9	10	TBA
1000.63.400	M63x1.5	35.0-40.0	70	37	10	5	TBA
1000.63.460	M63x1.5	40.0-46.0	70	37	10	5	TBA
1000.63.520	M63x1.5	46.0-52.0	70	37	10	5	TBA
1000.75.500	M75x1.5	45.0-50.0	80	38	11	1	TBA
1000.75.560	M75x1.5	50.0-56.0	80	38	11	1	TBA
1000.75.630	M75x1.5	56.0-63.0	80	38	11	1	TBA
1000.85.700	M85x2.0	63.0-70.0	95	41	18	1	TBA
1000.95.750	M95x2.0	68.0-75.0	110	51	20	1	TBA
1000.95.800	M95x2.0	73.0-80.0	110	51	20	1	TBA
1000.100.850	M100x3.0	78.0-85.0	115	51	22	1	TBA
1000.105.900	M105x3.0	83.0-90.0	120	52	22	1	TBA
1000.115.950	M115x3.0	88.0-95.0	125	52	22	1	TBA

1) Metrisches Regelgewinde

1) Metric coarse-pitch thread

Kabelverschraubungen Progress® Messing

Kurzes Anschlussgewinde Pg

Cable glands Progress®

nickel-plated brass

Short entry thread Pg

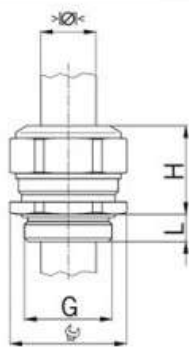

Material: Messing vernickelt
 Dichtung: TPE
 O-Ring: NBR
 Einsatztemperatur: -40°C / +100°C
 Schutzart: IP 68

Material: Nickel-plated brass
 Seal: TPE
 O-ring: NBR
 Temperature range: -40°C / +100°C
 Protection class: IP 68

Progress MS



**Einteiliger Dichtungseinsatz
 nicht durchgehend isolierend**

**One-piece sealing insert
 not overall length insulated**



Art-Nr.	G	>Ø< mm	mm	H mm	L mm		Price RM Each
1000.07.050	Pg 7	3.5-5.0	15	17	6	50	TBA
1000.07.065	Pg 7	5.0-6.5	15	17	6	50	TBA
1000.07.080	Pg 7	6.5-8.0	15	17	6	50	TBA
1000.09.045	Pg 9	3.5-4.5	18	20	6	50	TBA
1000.09.060	Pg 9	4.5-6.0	18	20	6	50	TBA
1000.09.080	Pg 9	6.0-8.0	18	20	6	50	TBA
1000.09.105	Pg 9	8.0-10.5	18	22	6	50	TBA
1000.11.055	Pg 11	4.0-5.5	21	21	6	50	TBA
1000.11.085	Pg 11	5.5-8.5	21	21	6	50	TBA
1000.11.120	Pg 11	8.5-12.0	21	21	6	50	TBA
1000.13.080	Pg 13	6.0-8.0	24	21	6	50	TBA
1000.13.110	Pg 13	8.0-11.0	24	21	6	50	TBA
1000.13.150	Pg 13	11.0-15.0	24	23	6	50	TBA
1000.16.080	Pg 16	6.0-8.0	24	23	6	50	TBA
1000.16.110	Pg 16	8.0-11.0	24	23	6	50	TBA
1000.16.150	Pg 16	11.0-15.0	24	23	6	50	TBA
1000.21.125	Pg 21	9.5-12.5	30	28	7.5	25	TBA
1000.21.160	Pg 21	12.5-16.0	30	28	7.5	25	TBA
1000.21.205	Pg 21	16.0-20.5	30	28	7.5	25	TBA
1000.29.190	Pg 29	16.0-19.0	38	28	8	25	TBA
1000.29.230	Pg 29	19.0-23.0	38	28	8	25	TBA
1000.29.275	Pg 29	23.0-27.5	38	28	8	25	TBA
1000.36.260	Pg 36	21.5-26.0	50	32	8	10	TBA
1000.36.305	Pg 36	26.0-30.5	50	32	8	10	TBA
1000.36.350	Pg 36	30.5-35.0	50	32	8	10	TBA
1000.42.330	Pg 42	29.0-33.0	55	34	10	10	TBA
1000.42.370	Pg 42	33.0-37.0	55	34	10	10	TBA
1000.42.420	Pg 42	37.0-42.0	55	34	10	10	TBA
1000.48.370	Pg 48	32.0-37.0	65	37	11	10	TBA
1000.48.430	Pg 48	37.0-43.0	65	37	11	10	TBA
1000.48.490	Pg 48	43.0-49.0	65	37	11	10	TBA

Kabelverschraubungen Progress®
rostfreier Stahl A2
 Langes Anschlussgewinde metrisch

Cable glands Progress®
stainless steel A2
 Long entry thread metric

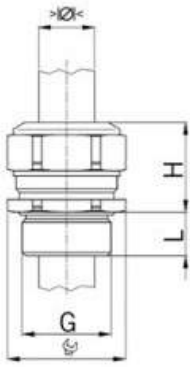

Material: CrNi Stahl A2 (DIN EN 1.4305 / AISI 303)
 Kennzeichnung: 1 Rille
 Dichtung: TPE
 O-Ring : NBR
 Zugentlastung: Nach EN 50262 Ausführung A
 Einsatztemperatur: -40°C / +100°C
 Schutzart: IP 68

Material: CrNi stainless steel A2 (DIN EN 1.4305 / AISI 303)
 Identification: 1 groove
 Seal: TPE
 O-ring : NBR
 Strain relief: Acc. to EN 50262 version A
 Temperature range: -40°C / +100°C
 Protection class: IP 68

Progress S2



Einteiliger Dichtungseinsatz
nicht durchgehend isolierend

One-piece sealing insert
not overall length insulated

Art.-Nr.	G	>Ø< mm	mm	H mm	L mm		Price RM Each
1100.08.94.035	M 8x1.25 1)	2.5-3.5	11	14	10	50	TBA
1100.08.94.050	M 8x1.25 1)	3.5-5.0	11	14	10	50	TBA
1100.10.94.040	M10x1.5 1)	3.0-4.0	13	15	10	50	TBA
1100.10.94.060	M10x1.5 1)	4.0-6.0	13	15	10	50	TBA
1100.12.94.050	M12x1.5	3.5-5.0	17	17	10	50	TBA
1100.12.94.065	M12x1.5	5.0-6.5	17	17	10	50	TBA
1100.12.94.080	M12x1.5	6.5-8.0	17	17	10	50	TBA
1100.17.94.105	M16x1.5	8.0-10.5	19	20	10	50	TBA
1100.20.94.150	M20x1.5	11.0-15.0	24	21	10	50	TBA
1100.25.94.205	M25x1.5	16.0-20.5	30	25	11	25	TBA
1100.32.94.255	M32x1.5	21.0-25.5	36	28	13	25	TBA
1100.40.94.330	M40x1.5	28.5-33.0	46	31	13	10	TBA
1100.50.94.420	M50x1.5	37.0-42.0	55	34	14	10	TBA
1100.63.94.520	M63x1.5	46.0-52.0	70	37	14	5	TBA

1) Metrisches Regelgewinde

1) Metric coarse-pitch thread



Kabelverschraubungen Progress®
rostfreier Stahl A2
 Langes Anschlussgewinde Pg

Cable glands Progress®
stainless steel A2
 Long entry thread Pg

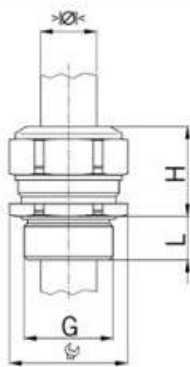

Material: CrNi Stahl A2 (DIN EN 1.4305 / AISI 303)
 Kennzeichnung: 1 Rille
 Dichtung: TPE
 O-Ring : NBR
 Einsatztemperatur: -40°C / +100°C
 Schutzart: IP 68

Material: CrNi stainless steel A2 (DIN EN 1.4305 / AISI 303)
 Identification: 1 groove
 Seal: TPE
 O-ring : NBR
 Temperature range: -40°C / +100°C
 Protection class: IP 68

Progress S2



Einteiliger Dichtungseinsatz
nicht durchgehend isolierend

One-piece sealing insert
not overall length insulated

Art.-Nr.	G	>Ø< mm	mm	H mm	L mm		Price RM Each
1100.07.94.050	Pg 7	3.5-5.0	17	17	10	50	TBA
1100.07.94.065	Pg 7	5.0-6.5	17	17	10	50	TBA
1100.07.94.080	Pg 7	6.5-8.0	17	17	10	50	TBA
1100.09.94.105	Pg 9	8.0-10.5	19	20	10	50	TBA
1100.11.94.120	Pg 11	8.5-12.0	22	21	10	50	TBA
1100.13.94.150	Pg 13	11.0-15.0	24	21	10	50	TBA
1100.16.94.150	Pg 16	11.0-15.0	24	21	10	50	TBA
1100.21.94.205	Pg 21	16.0-20.5	30	25	12	25	TBA
1100.29.94.275	Pg 29	23.0-27.5	41	28	12	25	TBA
1100.36.94.350	Pg 36	30.5-35.0	50	32	15	10	TBA
1100.42.94.420	Pg 42	37.0-42.0	55	34	15	10	TBA
1100.48.94.490	Pg 48	43.0-49.0	65	37	15	10	TBA



Kabelverschraubungen Progress® Kunststoff GFK
erhöhte Sicherheit Ex e II
 Anschlussgewinde metrisch

Synthetic cable glands Progress® GFK
increased safety Ex e II
 Entry thread metric

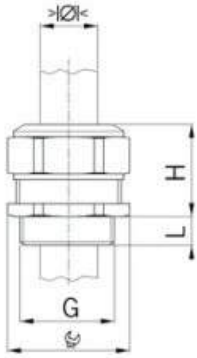

Material: Polyamid glasfaserverstärkt
 Dichtung: TPE / NBR wenn Klemmbereich ³⁾
 Einsatztemperatur: -20°C / +85°C
 Schutzart: IP 68
 Prüfnorm: EN 60079-0 / EN 60079-7
 Zündschutzart: Erhöhte Sicherheit «e»
 Gruppe: II
 Kat./Zone: 2 G/D / 1, 2, 21, 22
 Zertifikat: EG-Baumuster-Prüfbescheinigung PTB 02 ATEX 1126X

Material: Polyamide glass fiber reinforced
 Seal: TPE / NBR if clamping range ³⁾
 Temperature range: -20°C / +85°C
 Protection class: IP 68
 Test standard: EN 60079-0 / EN 60079-7
 Ignition prot. category: Increased safety «e»
 Group: II
 Cat./zone: 2 G/D / 1, 2, 21, 22
 Certificate: EC-type-examination certificate PTB 02 ATEX 1126X

Progress GFK EX



Schwarz RAL 9005
Einteiliger Dichtungseinsatz

Black RAL 9005
One-piece sealing insert



Art.-Nr.	G	>Ø< mm	mm	H mm	L mm		Price RM Each
EX1540.17.060	M16x1.5	4.5-6.0	21	26	12	50	TBA
EX1540.17.080	M16x1.5	6.0-8.0	21	26	12	50	TBA
EX1540.20.080	M20x1.5	6.0-8.0	27	28	13	50	TBA
EX1540.20.110	M20x1.5	8.0-11.0	27	28	13	50	TBA
EX1540.25.125	M25x1.5	9.5-12.5	34	33	13	25	TBA
EX1540.25.160	M25x1.5	12.5-16.0	34	33	13	25	TBA
EX1540.25.190	M25x1.5	16.0-19.0	34	33	13	25	TBA
EX1540.25.205	M25x1.5	19.0-20.5	34	33	13	25	TBA
EX1540.32.210	M32x1.5	20.0-21.0	41	35	15	25	TBA
EX1540.32.220	M32x1.5	21.0-22.0 ³⁾	41	35	15	25	TBA
EX1540.32.230	M32x1.5	22.0-23.0 ³⁾	41	35	15	25	TBA
EX1540.32.255	M32x1.5	23.0-25.5	41	35	15	25	TBA
EX1540.40.270	M40x1.5	25.5-27.0 ³⁾	50	40	15	10	TBA
EX1540.40.285	M40x1.5	27.0-28.5	50	40	15	10	TBA
EX1540.40.300	M40x1.5	28.5-30.0 ³⁾	50	40	15	10	TBA
EX1540.40.330	M40x1.5	30.0-33.0	50	40	15	10	TBA
EX1540.50.350	M50x1.5	33.0-35.0 ³⁾	60	42	16	10	TBA
EX1540.50.370	M50x1.5	35.0-37.0	60	42	16	10	TBA
EX1540.50.390	M50x1.5	37.0-39.0 ³⁾	60	42	16	10	TBA
EX1540.50.420	M50x1.5	39.0-42.0	60	42	16	10	TBA
EX1540.63.440	M63x1.5	42.0-44.0 ³⁾	75	48	16	5	TBA
EX1540.63.460	M63x1.5	44.0-46.0	75	48	16	5	TBA
EX1540.63.480	M63x1.5	46.0-48.0 ³⁾	75	48	16	5	TBA
EX1540.63.520	M63x1.5	48.0-52.0	75	48	16	5	TBA

Kabelverschraubungen Progress® Kunststoff GFK
erhöhte Sicherheit Ex e II
 Anschlussgewinde Pg

Synthetic cable glands Progress® GFK
increased safety Ex e II
 Entry thread Pg

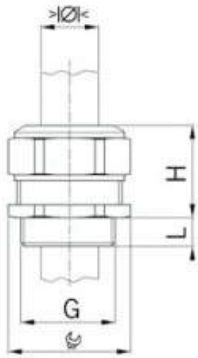

Material: Polyamid glasfaserverstärkt
 Dichtung: TPE / NBR wenn Klemmbereich ³⁾
 Einsatztemperatur: -20°C / +85°C
 Schutzart: IP 68
 Prüfnorm: EN 60079-0 / EN 60079-7
 Zündschutzart: Erhöhte Sicherheit «e»
 Gruppe: II
 Kat./Zone: 2 G/D / 1, 2, 21, 22
 Zertifikat: EG-Baumusterprüfbescheinigung PTB 02 ATEX 1126X

Material: Polyamide glass fiber reinforced
 Seal: TPE / NBR if clamping range ³⁾
 Temperature range: -20°C / +85°C
 Protection class: IP 68
 Test standard: EN 60079-0 / EN 60079-7
 Ignition prot. category: Increased safety «e»
 Group: II
 Cat./zone: 2 G/D / 1, 2, 21, 22
 Certificate: EC-type-examination certificate PTB 02 ATEX 1126X

Progress GFK EX



Schwarz RAL 9005
Einteiliger Dichtungseinsatz

Black RAL 9005
One-piece sealing insert



Art.-Nr.	G	>Ø< mm	Ø mm	H mm	L mm		Price RM Each
EX1540.09.060	Pg 9	4.5-6.0	21	26	12	50	TBA
EX1540.09.080	Pg 9	6.0-8.0	21	26	12	50	TBA
EX1540.11.055	Pg 11	4.0-5.5	24	28	12	50	TBA
EX1540.11.085	Pg 11	5.5-8.5	24	28	12	50	TBA
EX1540.13.080	Pg 13	6.0-8.0	27	28	13	50	TBA
EX1540.13.110	Pg 13	8.0-11.0	27	28	13	50	TBA
EX1540.16.080	Pg 16	6.0-8.0	27	28	13	50	TBA
EX1540.16.110	Pg 16	8.0-11.0	27	28	13	50	TBA
EX1540.21.125	Pg 21	9.5-12.5	34	33	13	25	TBA
EX1540.21.160	Pg 21	12.5-16.0	34	33	13	25	TBA
EX1540.21.190	Pg 21	16.0-19.0	34	33	13	25	TBA
EX1540.21.205	Pg 21	19.0-20.5	34	33	13	25	TBA
EX1540.29.210	Pg 29	19.5-21.0 ³⁾	41	36	13	25	TBA
EX1540.29.230	Pg 29	21.0-23.0	41	36	13	25	TBA
EX1540.29.250	Pg 29	23.0-25.0 ³⁾	41	36	13	25	TBA
EX1540.29.275	Pg 29	25.0-27.5	41	36	13	25	TBA
EX1540.36.285	Pg 36	27.0-28.5 ³⁾	55	42	16	10	TBA
EX1540.36.305	Pg 36	28.5-30.5	55	42	16	10	TBA
EX1540.36.325	Pg 36	30.5-32.5 ³⁾	55	42	16	10	TBA
EX1540.36.350	Pg 36	32.5-35.0	55	42	16	10	TBA
EX1540.42.350	Pg 42	33.0-35.0 ³⁾	60	42	16	10	TBA
EX1540.42.370	Pg 42	35.0-37.0	60	42	16	10	TBA
EX1540.42.390	Pg 42	37.0-39.0 ³⁾	60	42	16	10	TBA
EX1540.42.420	Pg 42	39.0-42.0	60	42	16	10	TBA
EX1540.48.430	Pg 48	41.0-43.0	70	46	16	5	TBA
EX1540.48.450	Pg 48	43.0-45.0 ³⁾	70	46	16	5	TBA
EX1540.48.470	Pg 48	45.0-47.0 ³⁾	70	46	16	5	TBA
EX1540.48.490	Pg 48	47.0-49.0	70	46	16	5	TBA

Kabelverschraubungen Progress® Messing
erhöhte Sicherheit Ex e II
 Kurzes Anschlussgewinde metrisch

Cable glands Progress® nickel-plated
brass increased safety Ex e II
 Short entry thread metric

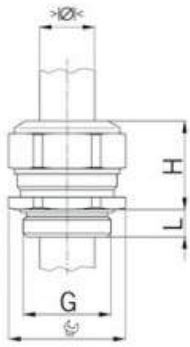

Material: Messing vernickelt
 Dichtung: TPE
 Einsatztemperatur: -40°C / +100°C
 Schutzart: IP 68
 Prüfnorm: EN 60079-0 / EN 60079-7
 Zündschutzart: Erhöhte Sicherheit «e»
 Gruppe: II
 Kat./Zone: 2 G/D / 1, 2, 21, 22
 Zertifikat: EG-Baumusterprüfbescheinigung PTB 02 ATEX 1126X

Material: Nickel-plated brass
 Seal: TPE
 Temperature range: -40°C / +100°C
 Protection class: IP 68
 Test standard: EN 60079-0 / EN 60079-7
 Ignition prot. category: Increased safety «e»
 Group: II
 Cat./zone: 2 G/D / 1, 2, 21, 22
 Certificate: EC-type-examination certificate PTB 02 ATEX 1126X

Progress MS EX



Einteiliger Dichtungseinsatz
nicht durchgehend isolierend

One-piece sealing insert
not overall length insulated



Art.-Nr.	G	>Ø< mm	mm	H mm	L mm		Price RM Each
EX1000.08.035	M 8x1.25 ¹⁾	3.0-3.5	11	14	5	50	TBA
EX1000.08.050	M 8x1.25 ¹⁾	4.0-5.0	11	14	5	50	TBA
EX1000.10.040	M10x1.5 ¹⁾	3.0-4.0	13	15	5	50	TBA
EX1000.10.060	M10x1.5 ¹⁾	4.5-6.0	13	15	5	50	TBA
EX1000.12.065	M12x1.5	5.0-6.5	15	17	5	50	TBA
EX1000.12.080	M12x1.5	6.5-8.0	15	17	5	50	TBA
EX1000.17.060	M16x1.5	4.5-6.0	18	20	5	50	TBA
EX1000.17.080	M16x1.5	6.0-8.0	18	20	5	50	TBA
EX1000.20.080	M20x1.5	6.0-8.0	24	21	6	50	TBA
EX1000.20.110	M20x1.5	8.0-11.0	24	21	6	50	TBA
EX1000.25.125	M25x1.5	9.5-12.5	30	25	7	25	TBA
EX1000.25.160	M25x1.5	12.5-16.0	30	25	7	25	TBA
EX1000.32.170	M32x1.5	14.0-17.0	36	28	8	25	TBA
EX1000.32.210	M32x1.5	17.0-21.0	36	28	8	25	TBA
EX1000.40.240	M40x1.5	20.0-24.0	46	31	8	10	TBA
EX1000.40.285	M40x1.5	24.0-28.5	46	31	8	10	TBA
EX1100.63.460	M63x1.5	40.0-46.0	70	37	14	5	TBA

1) Metrisches Regelgewinde

1) Metric coarse-pitch thread

Kabelverschraubungen Progress® Messing
erhöhte Sicherheit Ex e II
 Kurzes Anschlussgewinde Pg

Cable glands Progress® nickel-plated
brass increased safety Ex e II
 Short entry thread Pg

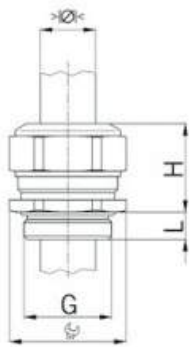

Material: Messing vernickelt
 Dichtung: TPE
 Einsatztemperatur: -40°C / +100°C
 Schutzart: IP 68
 Prüfnorm: EN 60079-0 / EN 60079-7
 Zündschutzart: Erhöhte Sicherheit «e»
 Gruppe: II
 Kat./Zone: 2 G/D / 1, 2, 21, 22
 Zertifikat: EG-Baumusterprüfbescheinigung PTB 02 ATEX 1126X

Material: Nickel-plated brass
 Seal: TPE
 Temperature range: -40°C / +100°C
 Protection class: IP 68
 Test standard: EN 60079-0 / EN 60079-7
 Ignition prot. category: Increased safety «e»
 Group: II
 Cat./zone: 2 G/D / 1, 2, 21, 22
 Certificate: EC-type-examination certificate PTB 02 ATEX 1126X

Progress MS EX



Einteiliger Dichtungseinsatz
nicht durchgehend isolierend

One-piece sealing insert
not overall length insulated



Art.-Nr.	G	>Ø< mm	mm	H mm	L mm		Price RM Each
EX1000.07.065	Pg 7	5.0-6.5	15	17	6	50	TBA
EX1000.07.080	Pg 7	6.5-8.0	15	17	6	50	TBA
EX1000.09.060	Pg 9	4.5-6.0	18	20	6	50	TBA
EX1000.09.080	Pg 9	6.0-8.0	18	20	6	50	TBA
EX1000.11.055	Pg 11	4.0-5.5	21	21	6	50	TBA
EX1000.11.085	Pg 11	5.5-8.5	21	21	6	50	TBA
EX1000.13.080	Pg 13	6.0-8.0	24	21	6	50	TBA
EX1000.13.110	Pg 13	8.0-11.0	24	21	6	50	TBA
EX1000.16.080	Pg 16	6.0-8.0	24	21	6	50	TBA
EX1000.16.110	Pg 16	8.0-11.0	24	21	6	50	TBA
EX1000.21.125	Pg 21	9.5-12.5	30	25	7.5	25	TBA
EX1000.21.160	Pg 21	12.5-16.0	30	25	7.5	25	TBA
EX1000.29.190	Pg 29	16.0-19.0	38	28	8	25	TBA
EX1000.29.230	Pg 29	19.0-23.0	38	28	8	25	TBA
EX1000.36.260	Pg 36	21.5-26.0	50	32	8	10	TBA
EX1000.36.305	Pg 36	26.0-30.5	50	32	8	10	TBA

HENSEL

E - Mobility

ENYSTATION

Standard conforming and combinable charging station



Get your customers safety under way.

HENSEL. Your partner for E - Mobility.

Full speed ahead for your customers with ENYSTATION!

Sole Distributor in Malaysia



TERMS AND CONDITIONS

- This price list supersedes all previous price lists.
- All taxes / levies are extra as applicable.
- Freight & Insurance : Extra at actuals.
- Prices are subject to change without notice.

AUTHORISED DISTRIBUTOR / DEALER

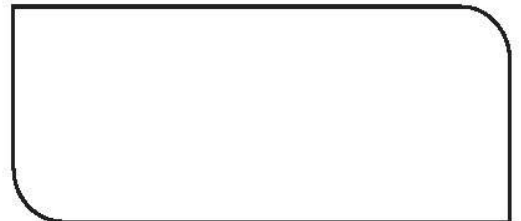

HEI SEA Edition: 03/2013



PENTA ENGINEERING SERVICES SDN BHD(986496-A)

Castello Energy Centre - Level 1

No.18,Jalan Industri PBP 9,

Taman Industri Pusat Bandar Puchong,

47100 Puchong, Selangor Darul Ehsan, Malaysia.

Tel : +603-8060 6881 Fax : +603-8060 6887